

# Instructions

## Service kits – Catalogue

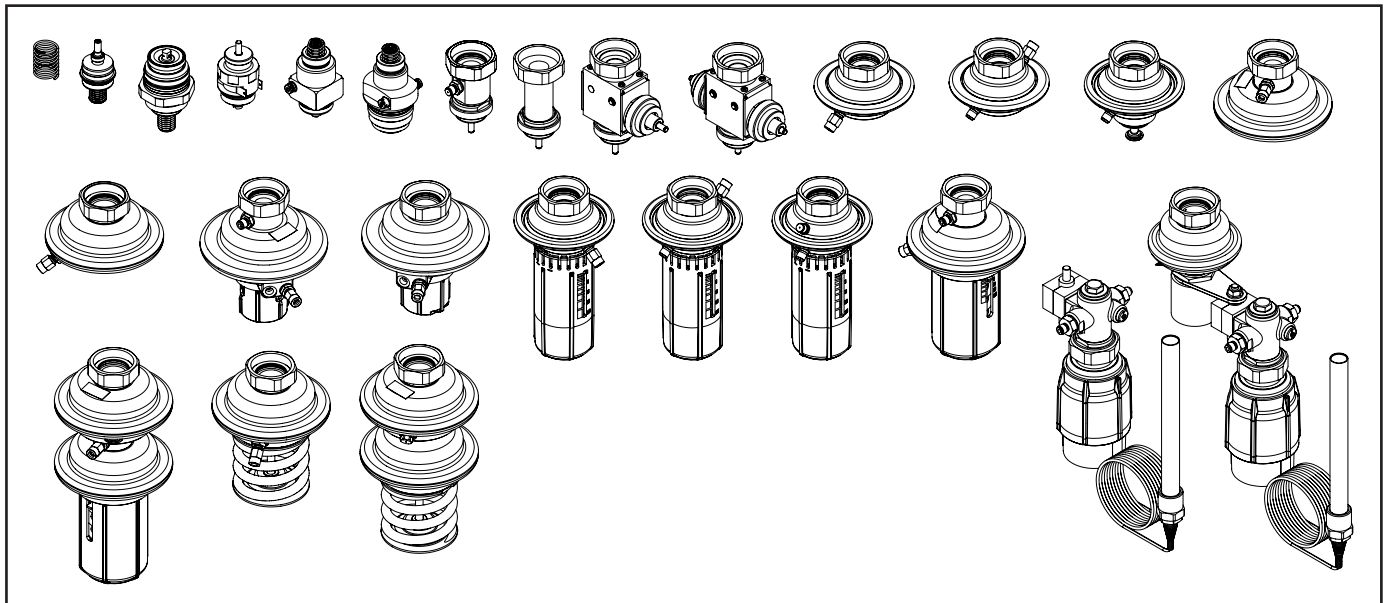

A	PN	DN	$\Delta p$ (bar)							Code No.
			$0.05 \div 0.5$ $0.1 \div 0.5$	$0.2 \div 1.0$	$0.3 \div 2.0$	$0.8 \div 1.6$	0.2	0.3	0.5	
16	15 $\div$ 32		-	x		-	x	-	-	003H1330
			-	-		-	-	x	-	003H1326
			-	-		-	-	-	x	003H1331
			-	-		x	-	-	-	003H1332
25	15 $\div$ 50			-	-		x		88835920	
	15 $\div$ 25			-	-		-	x	88835930	
	32 $\div$ 50			-	-		-	x	88835940	

M1	CuSn5ZnPb (Rg5)
M2	EN-GJS-400-18-LT (GGG 40.3)

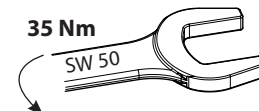

B	PN	DN	$\Delta p_b$ (bar)							Code No.
			$0.1 \div 0.5$	$0.2 \div 1.0$	$0.3 \div 2.0$	$0.8 \div 1.6$	0.2	0.3	0.5	
16	15 $\div$ 32							x		003H1330
								x		88835920
25	32 $\div$ 50						-		-	

Page	PN			Page	PN		
2	16	AVP, AVP-F, AVPB, AVPB-F, AVD, AVQ, AVQM	M1	10	25	SAVA	M1
2	16	AVPQ, AVPQ-F	M1				M2
3	16	AVPQ 4, AVPQ 4-F	M1	11	25	SAVD	M1
3	16	AVPA	M1				M2
4	25	AVP, AVP-F, AVPB, AVPB-F, AVPBT-F, AVD, AVQ, AVQT, AVQM, AVQMT	M1	12	25	AVPBT	M1
			M2	13	25	AVPBT	M2
5	25	AVPQ, AVPQ-F	M1	15	25	AVPQT	M1
			M2	16	25	AVPQT	M2
6	25	AVPQ 4, AVPQ 4-F	M1	18	25	VG	M1
			M2	18	25	VG, VGF	M2
7	25	AVPA	M1	18	25	VGS	M1
			M2	19	16	Control valve insert	M1
8	25	AVA	M1	20	25	Control valve insert	M1
			M2	21			M2
9	25	AVDS	M1	22	25	STL	M1, M2

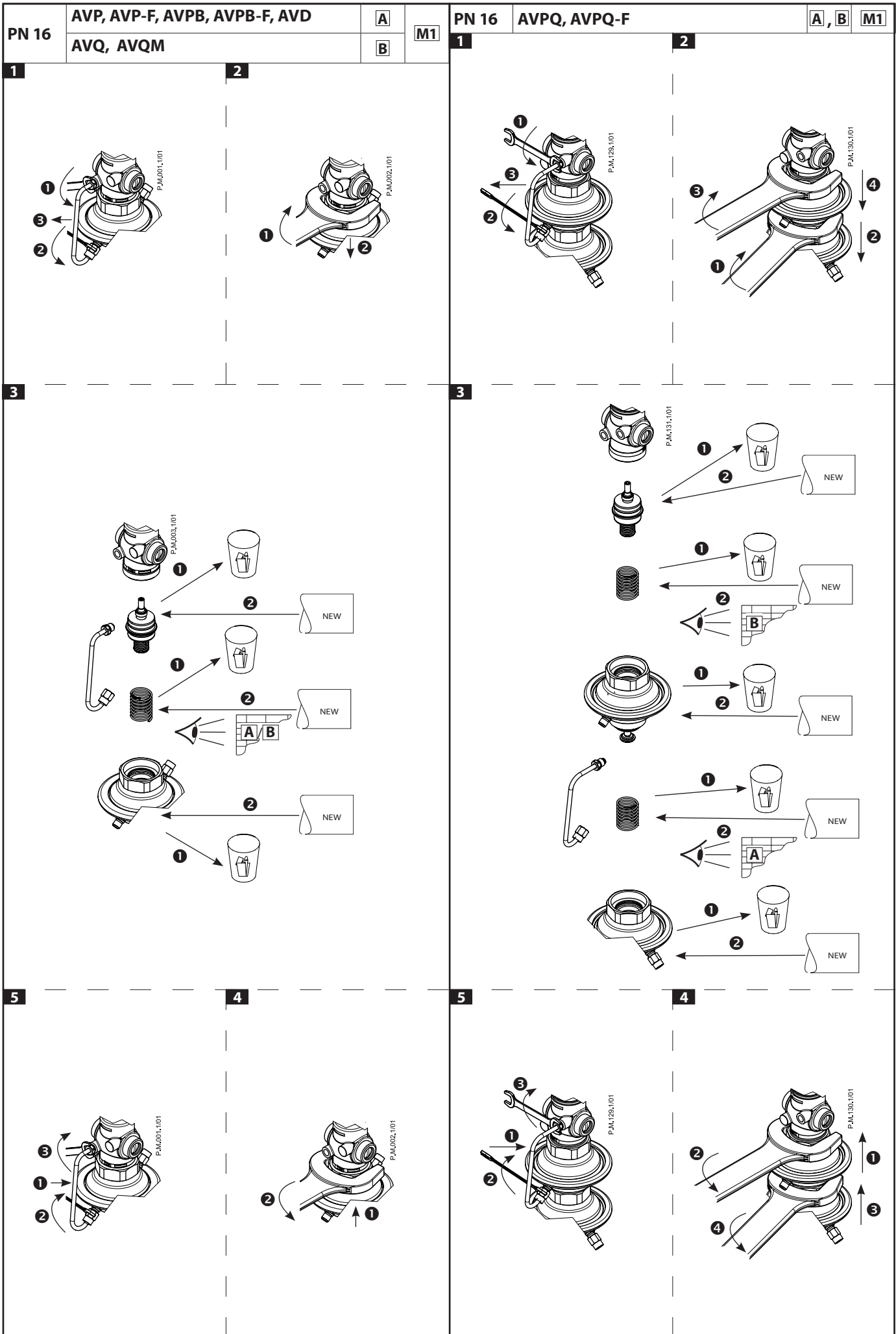

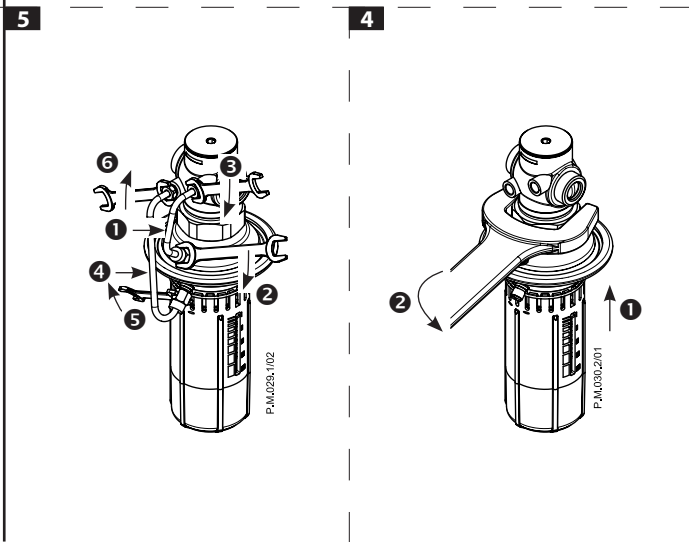
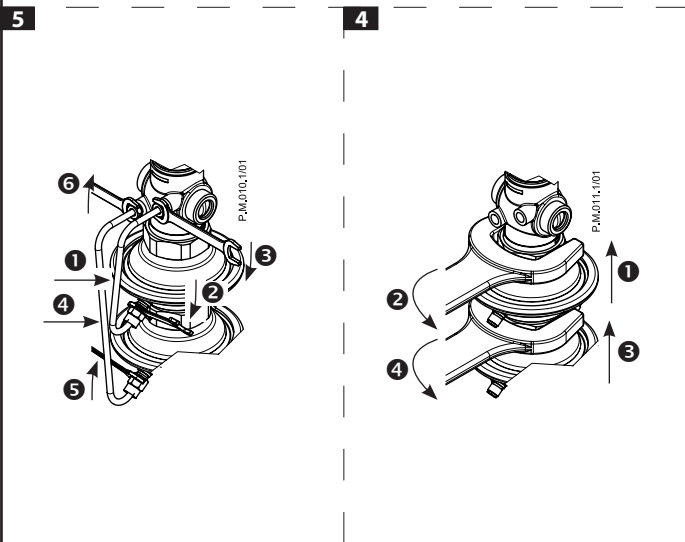
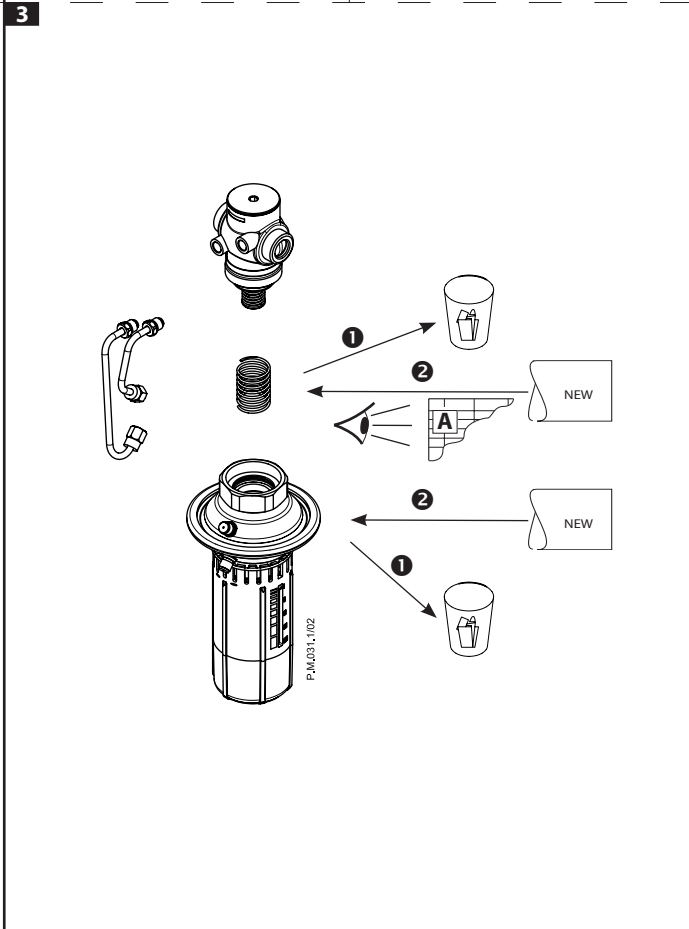
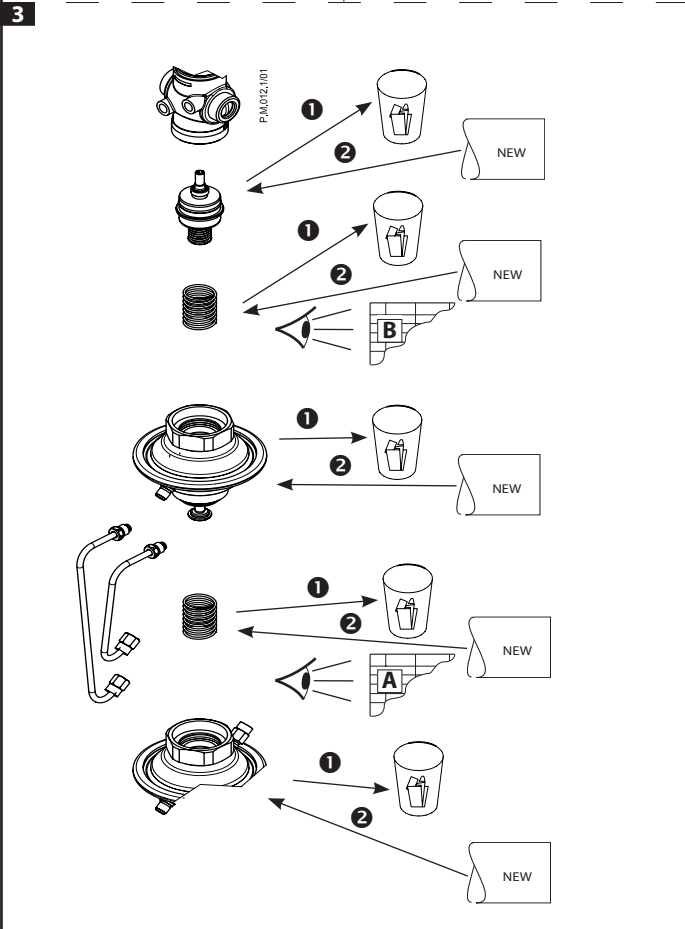
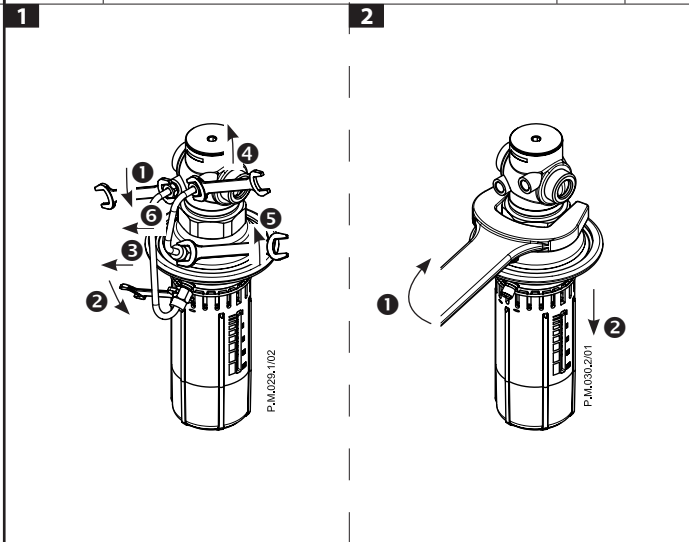
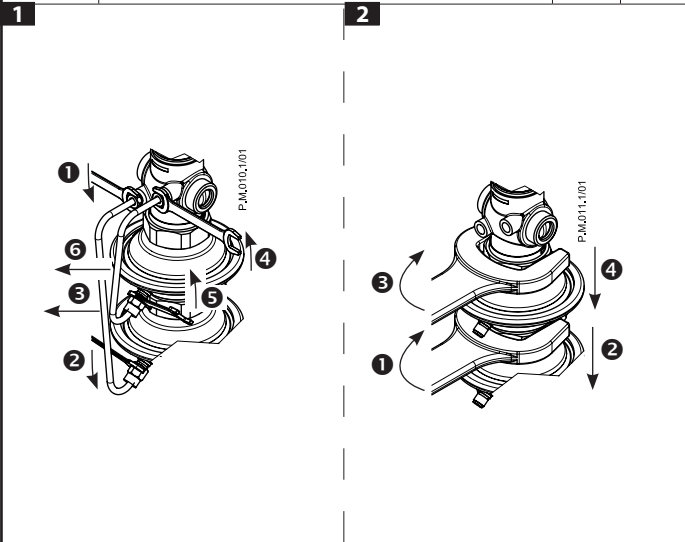

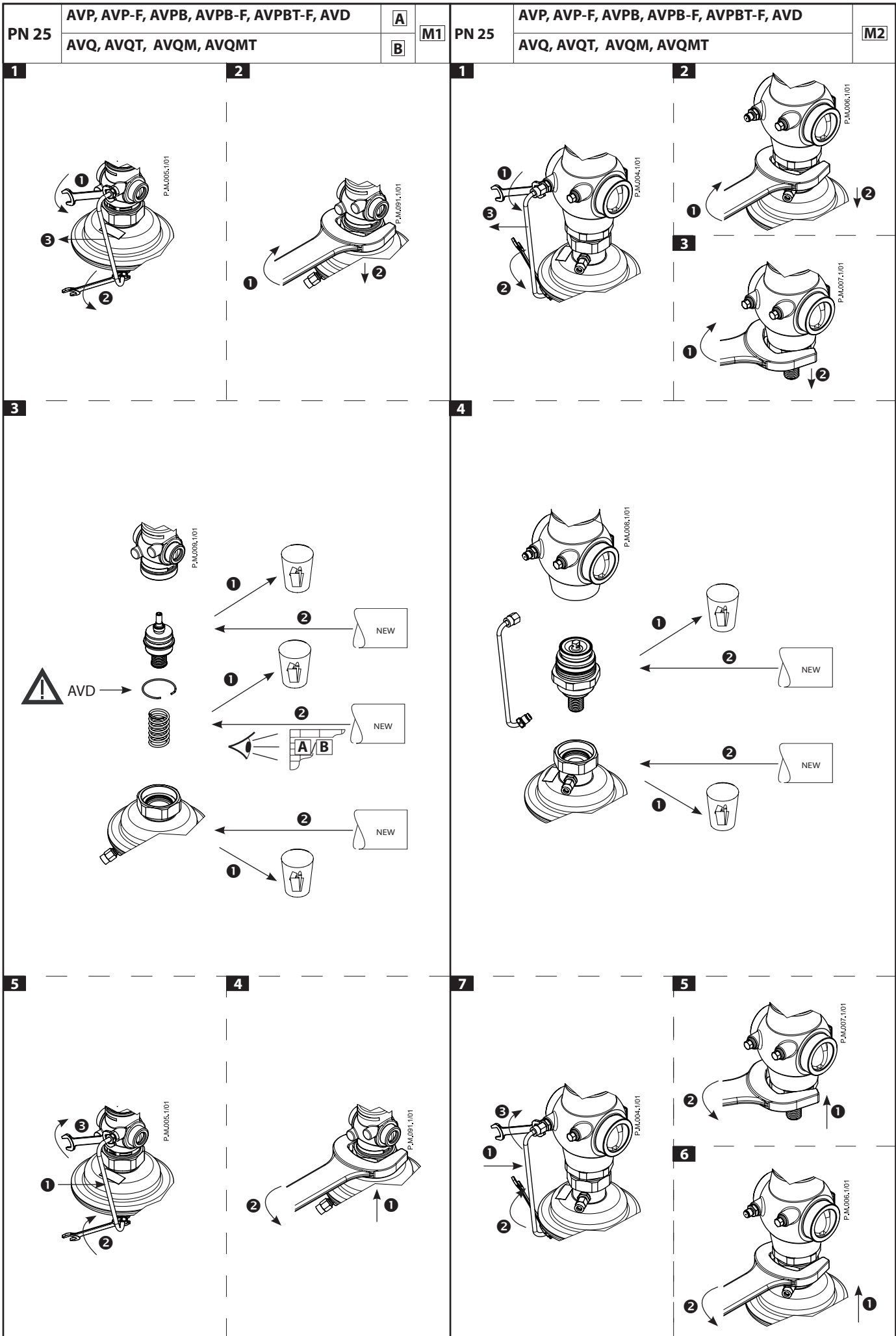

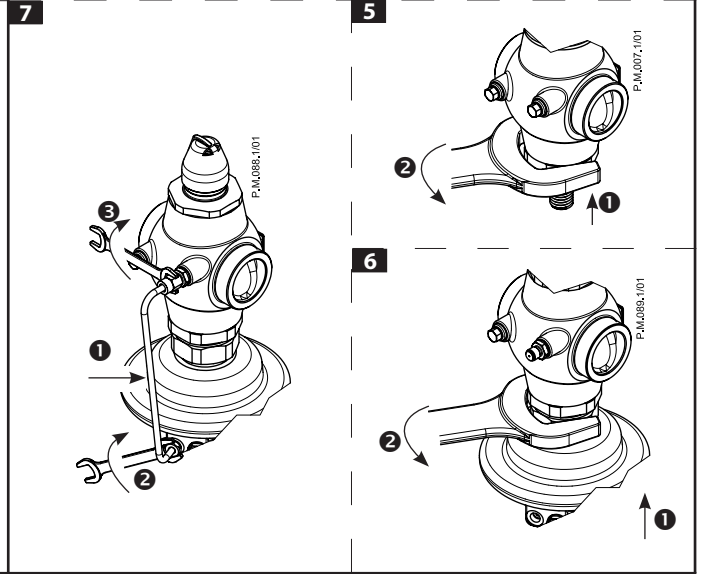
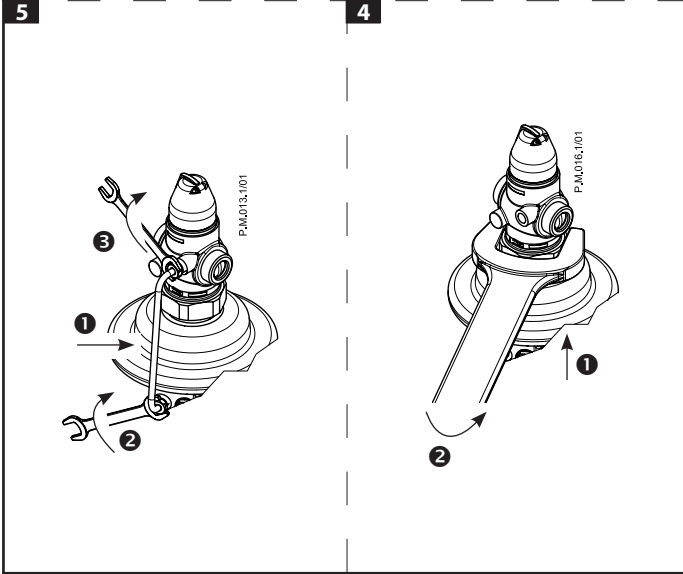
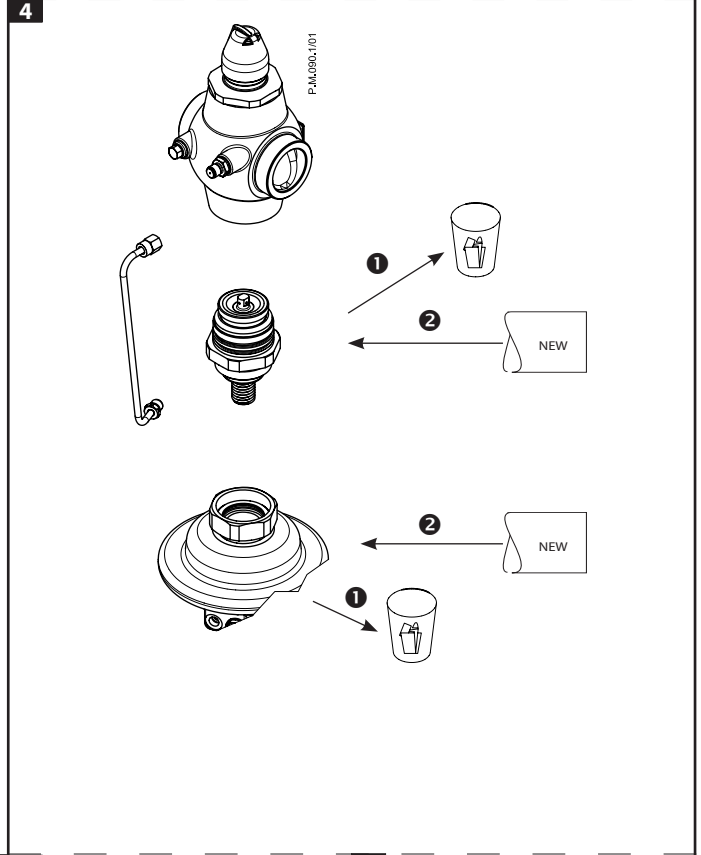
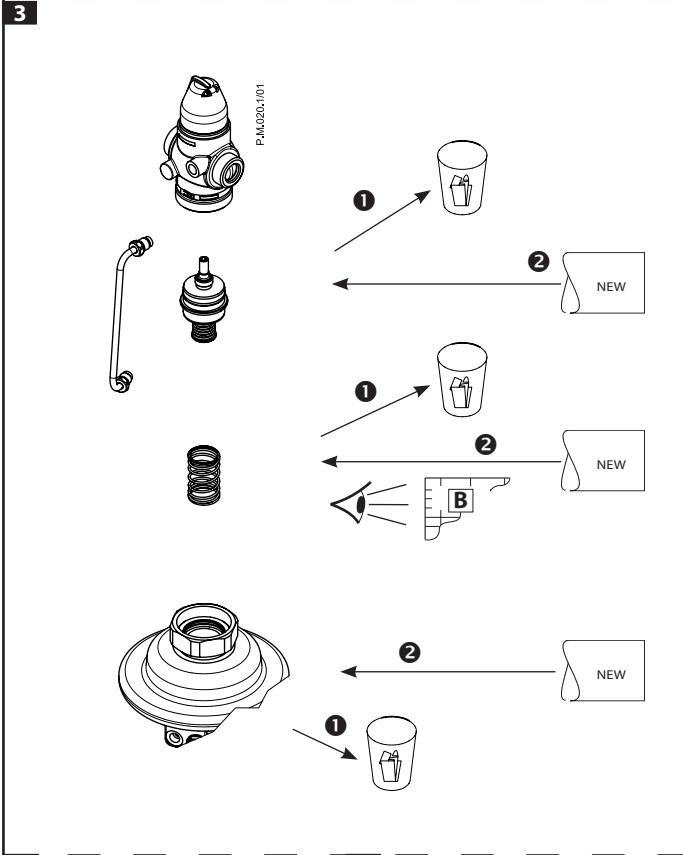
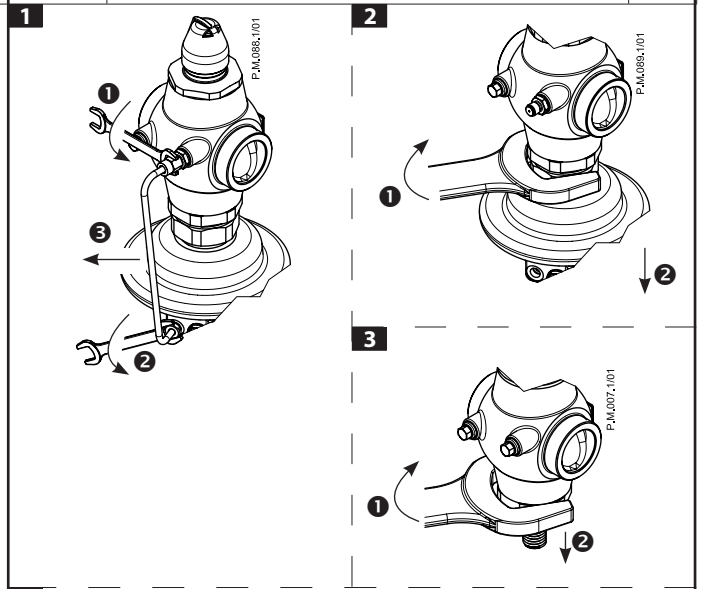
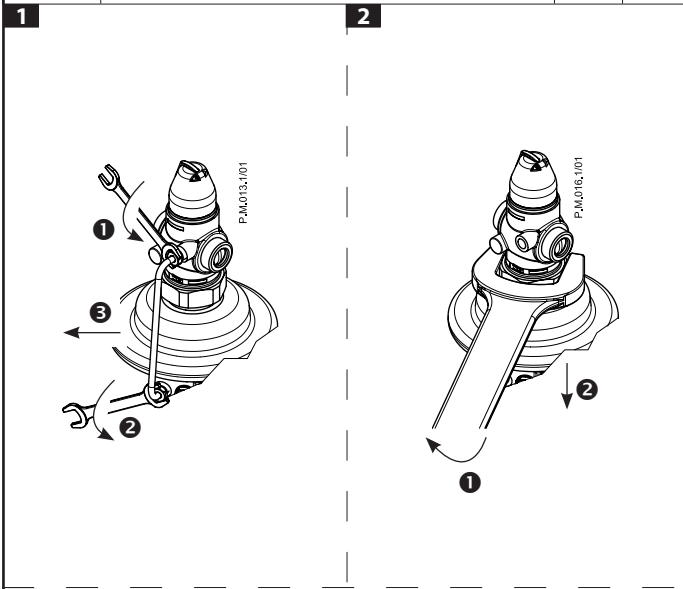

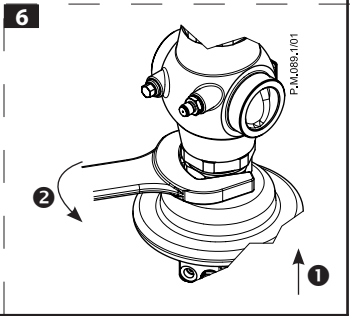
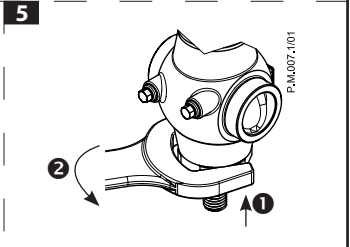
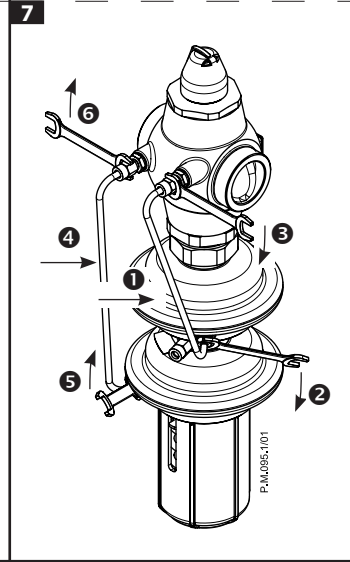
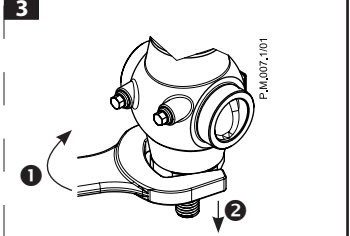
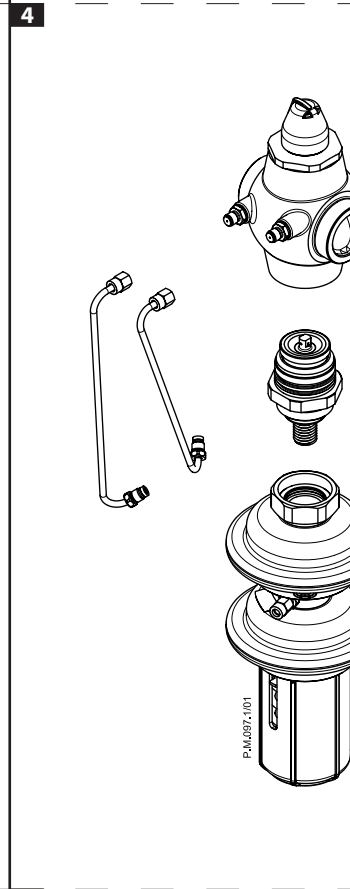
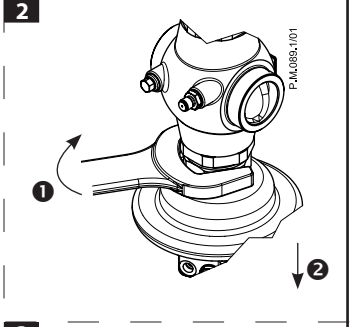
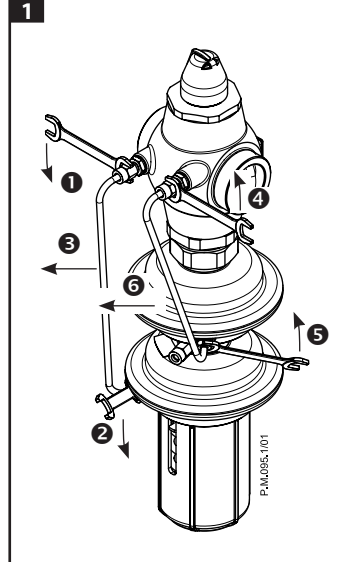
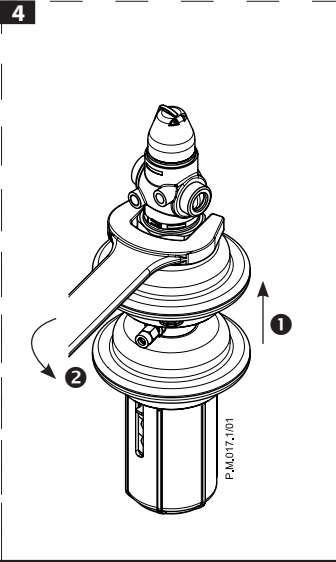
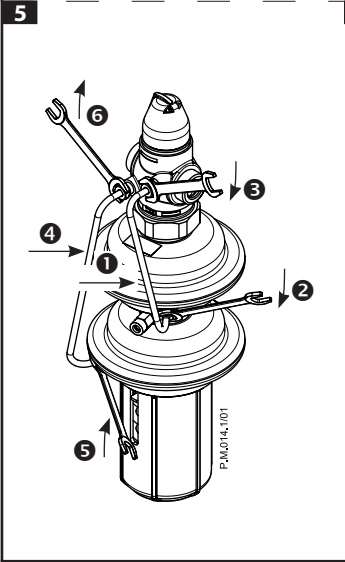
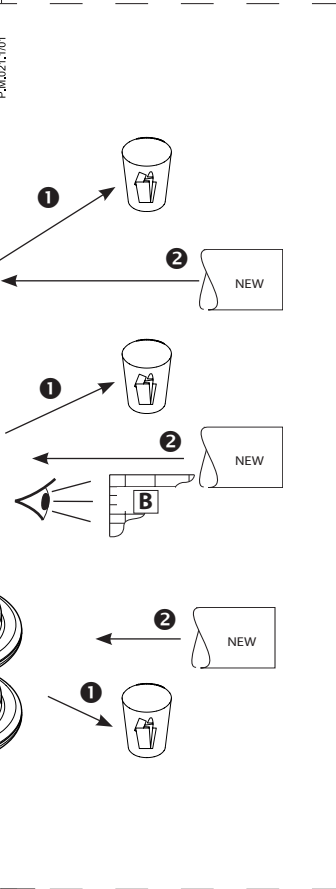
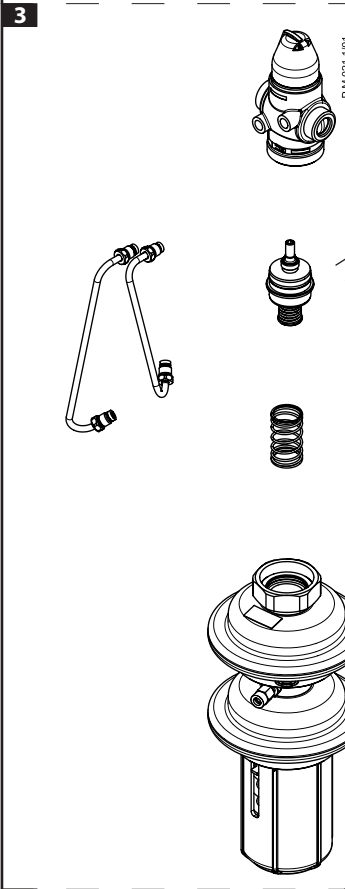
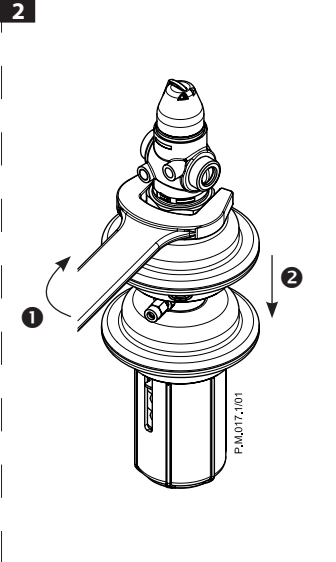
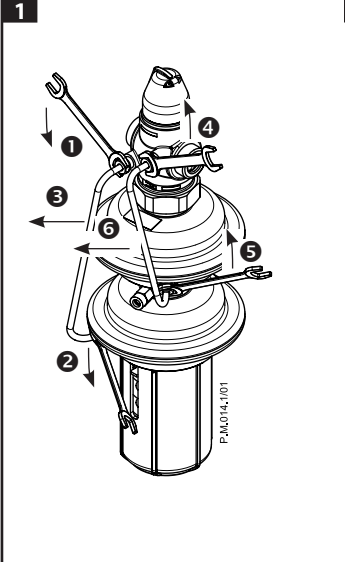



PN 25

AVPA

M1

PN 25

AVPA

M2

1

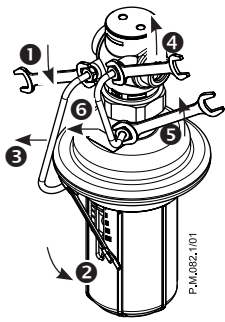

P.M.082.101

2

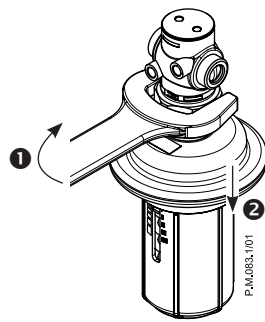

P.M.083.101

3

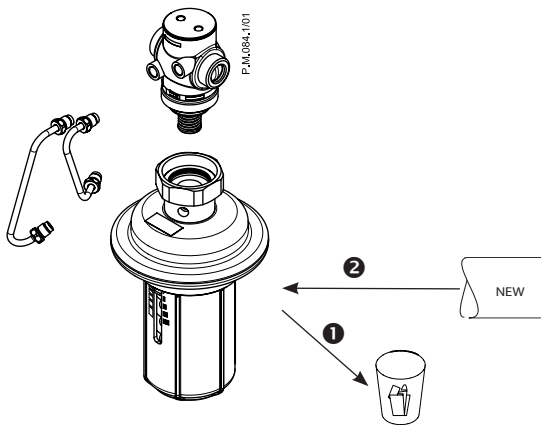

P.M.084.101

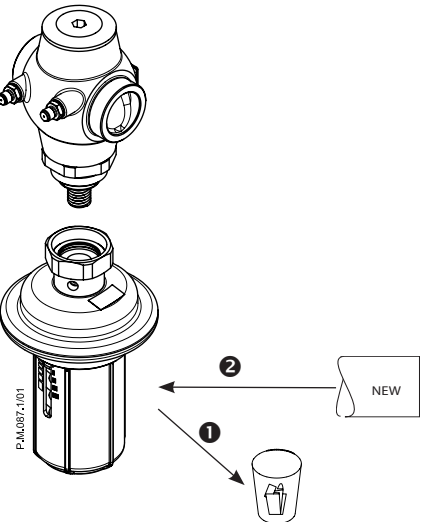

P.M.085.101

5

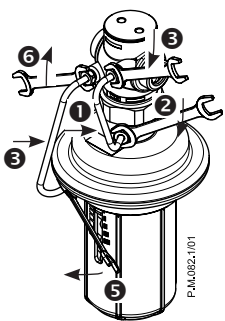

P.M.082.101

4

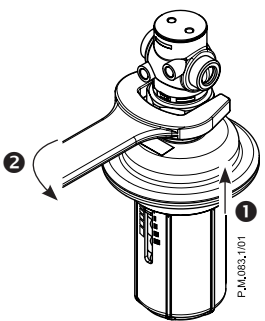

P.M.083.101

5

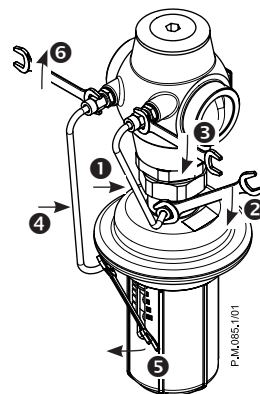

P.M.085.101

4

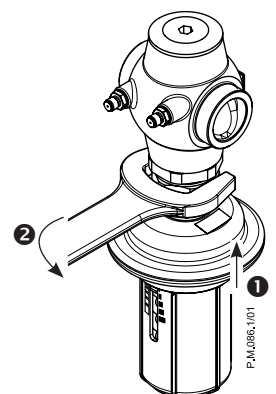

P.M.086.101

PN 25 AVA

M1

PN 25 AVA

M2

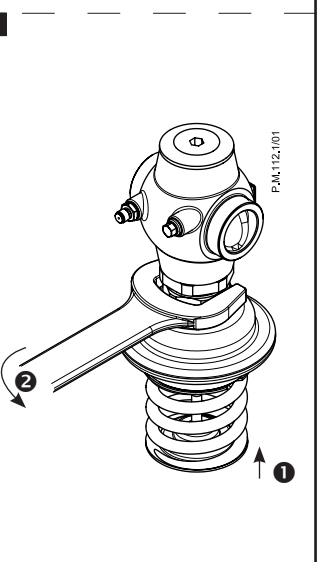
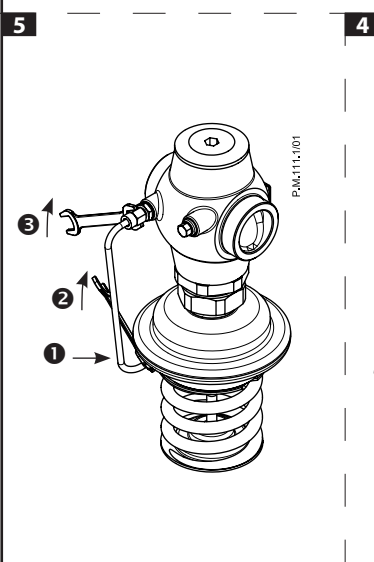
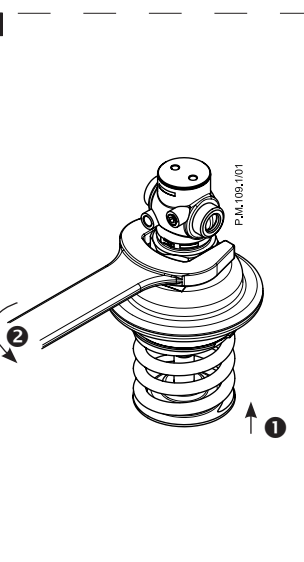
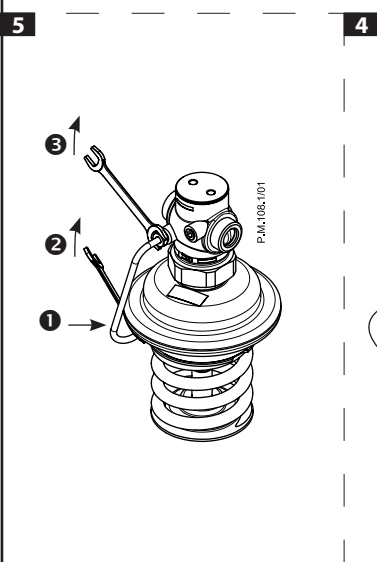
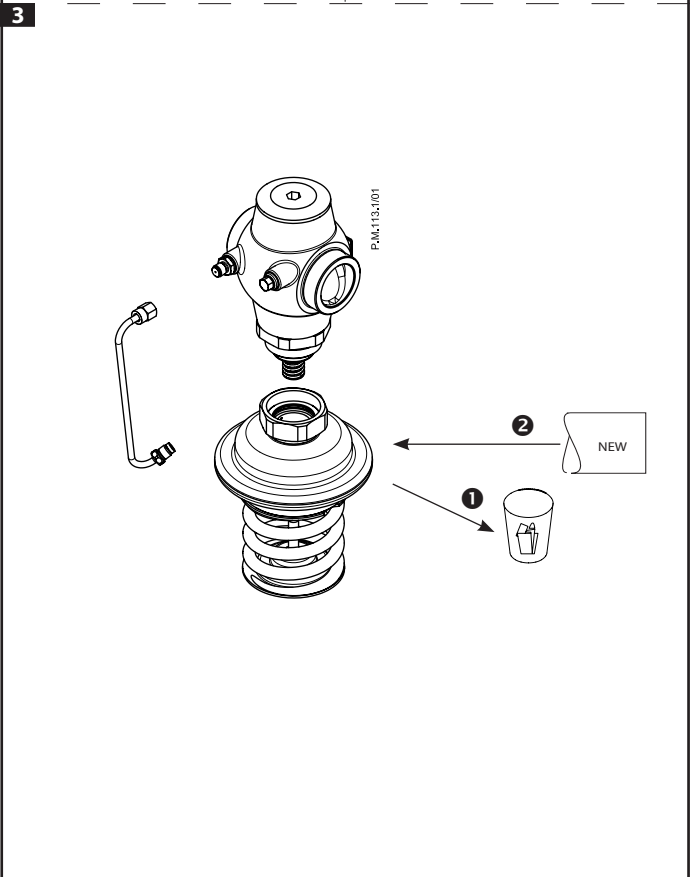
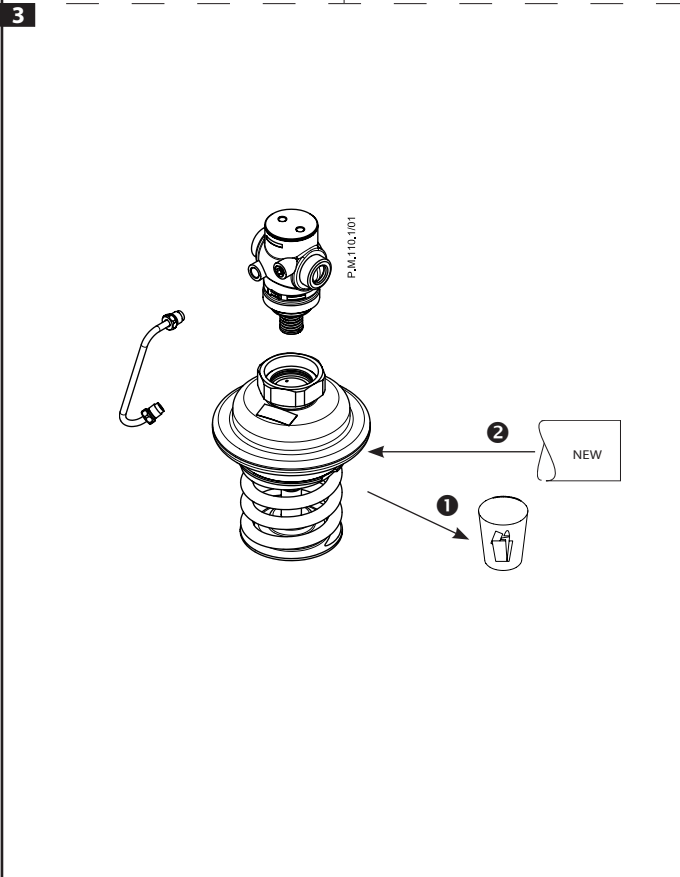
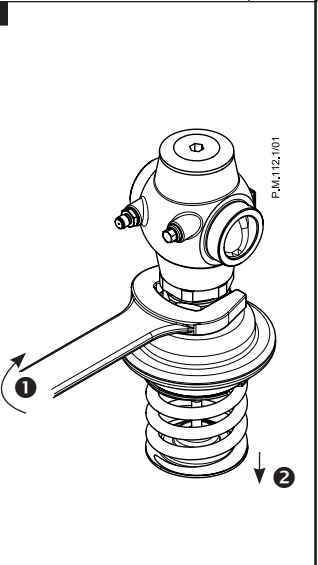
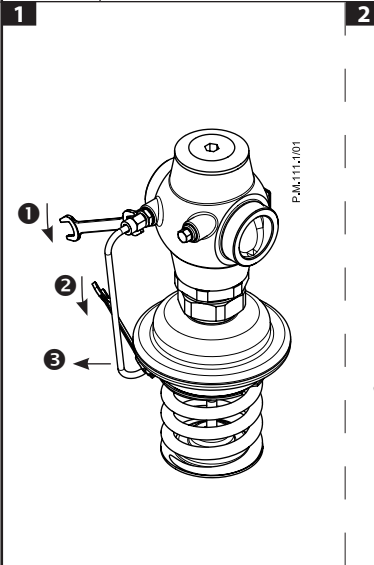
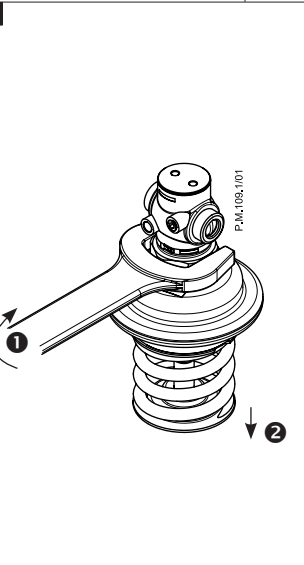
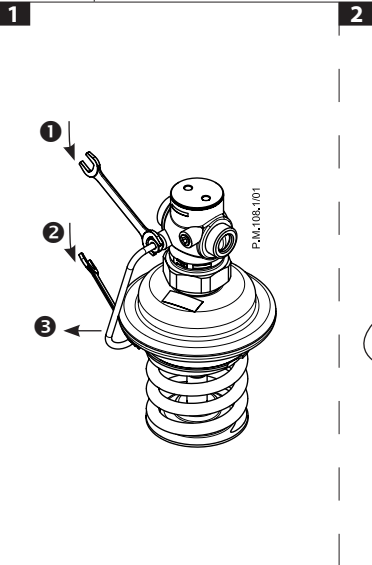



1

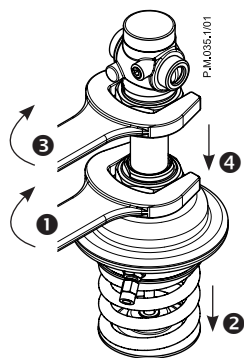

2

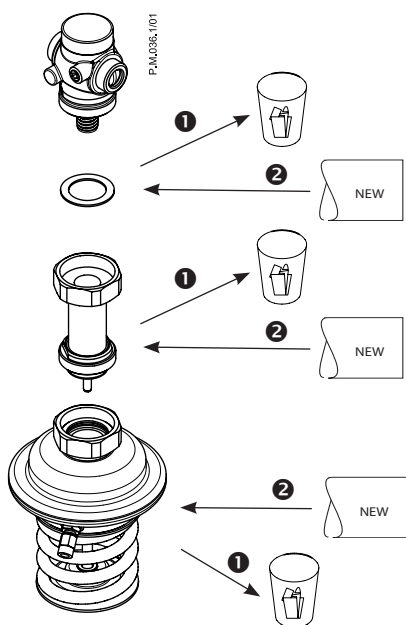

3

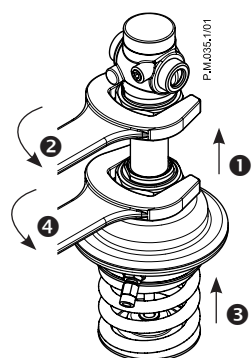

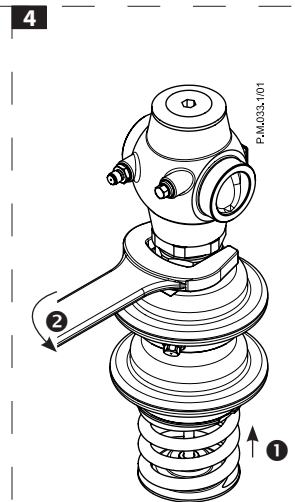
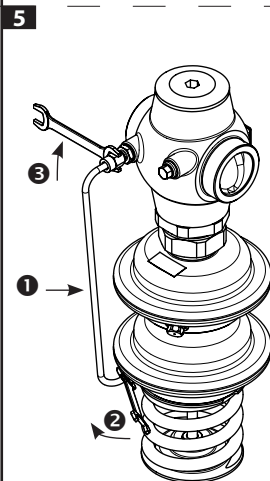
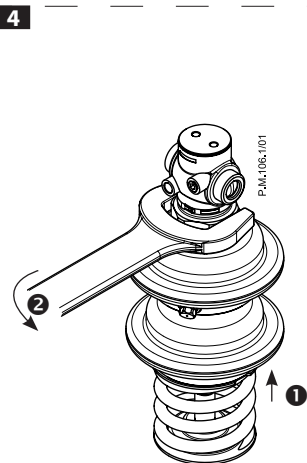
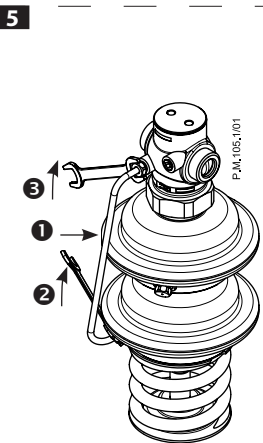
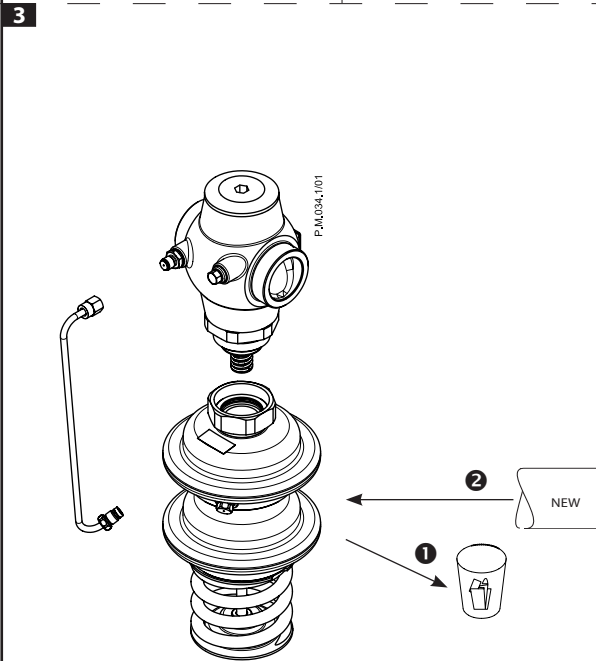
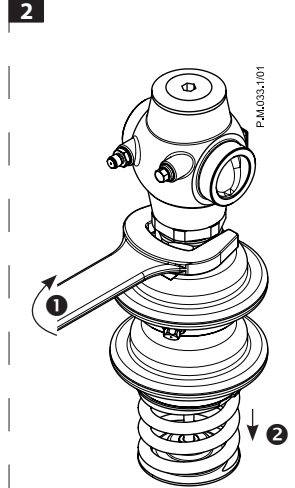
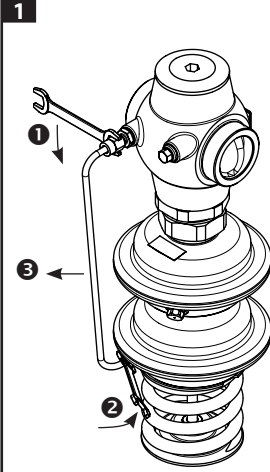
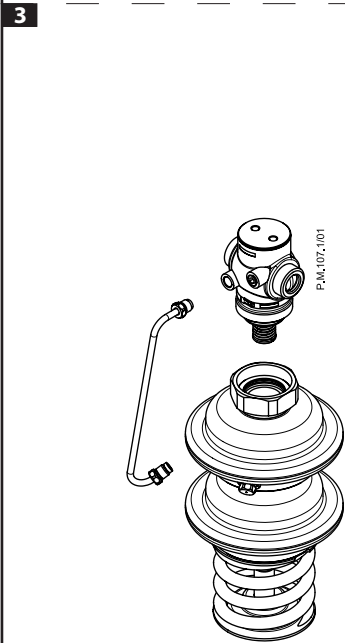
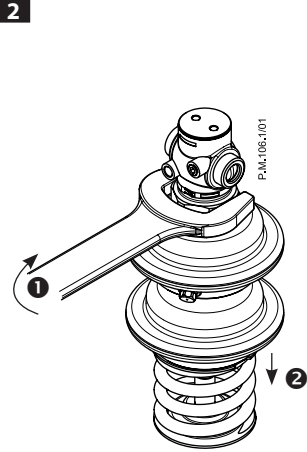
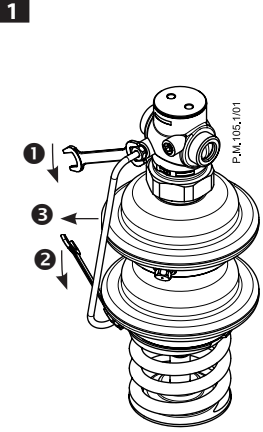

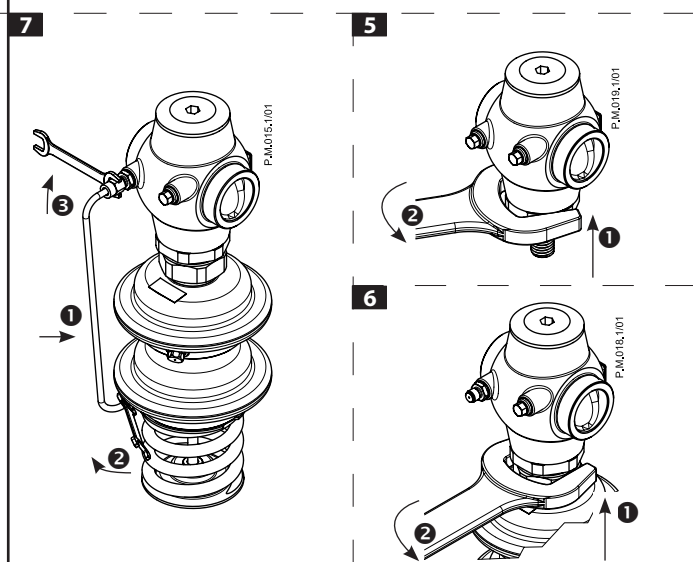
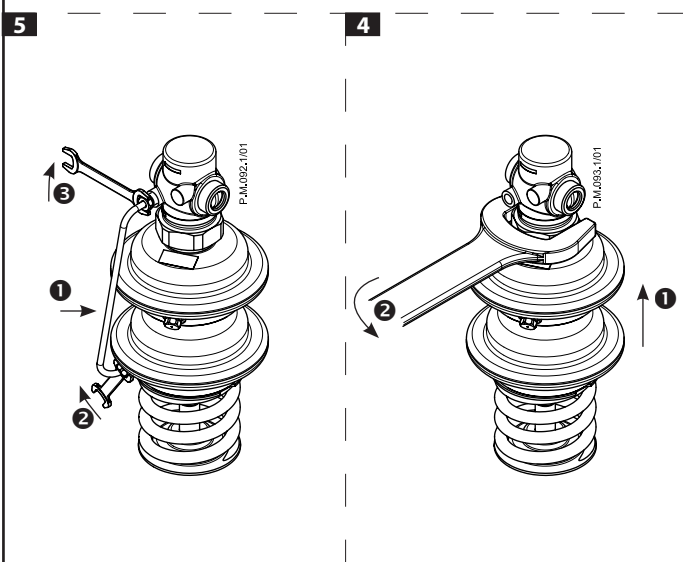
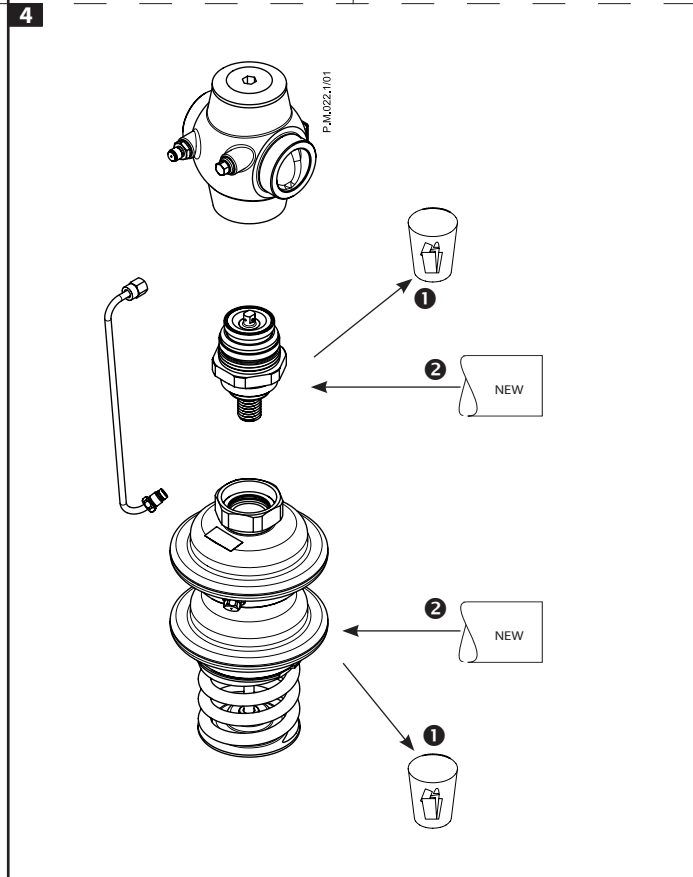
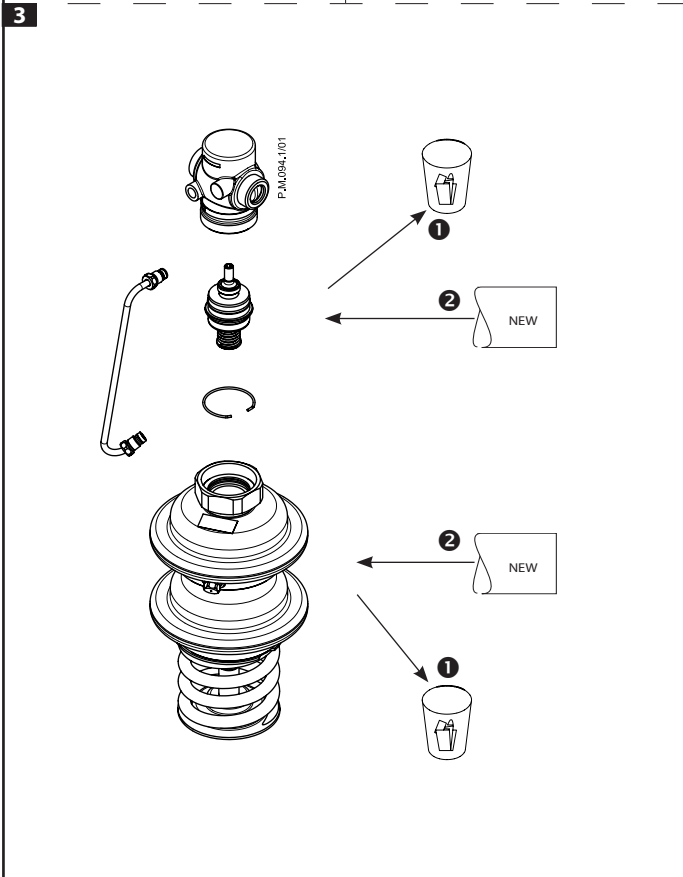
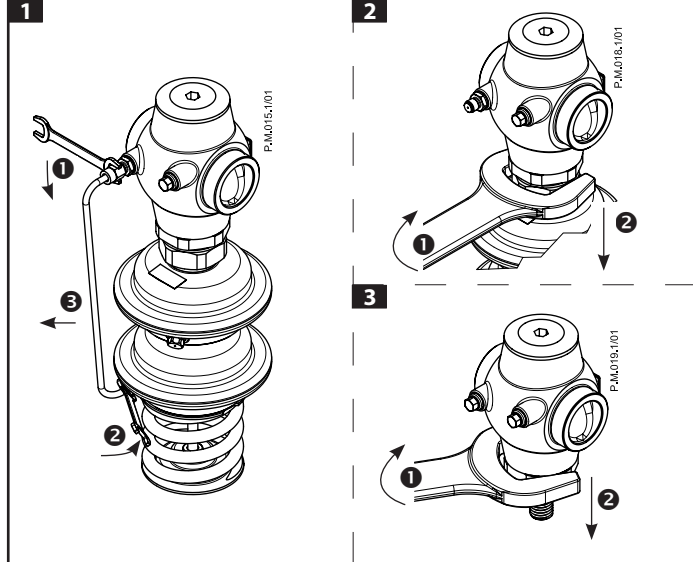
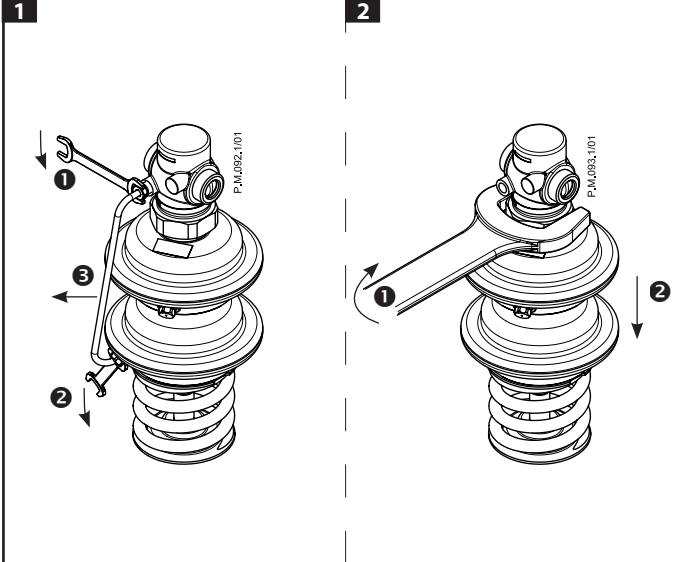

1

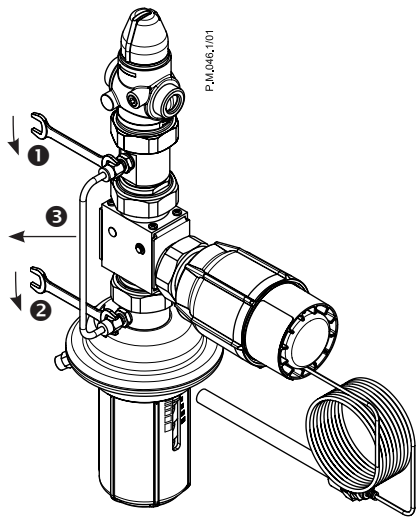

2

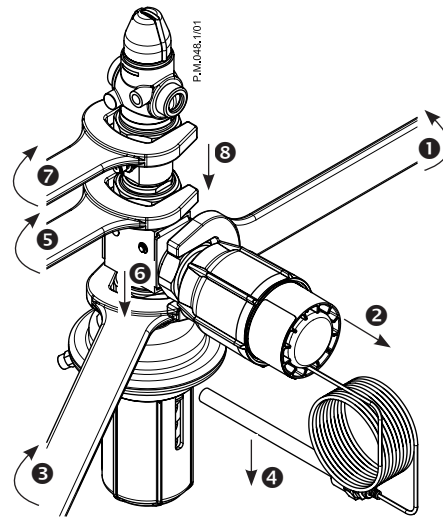

3

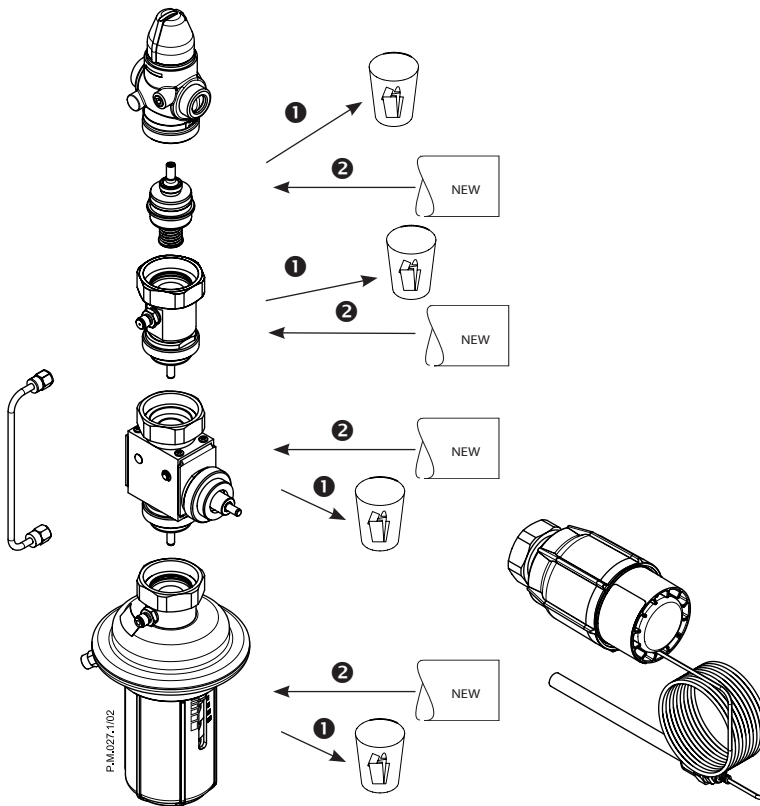

5

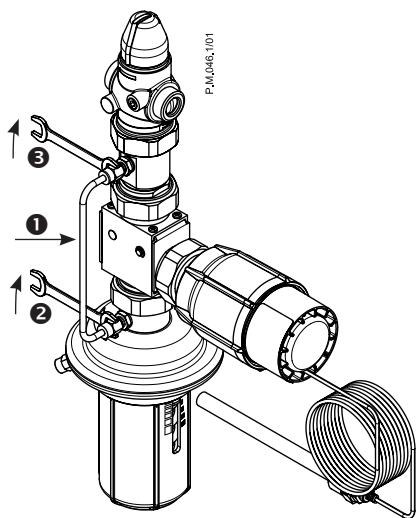

4

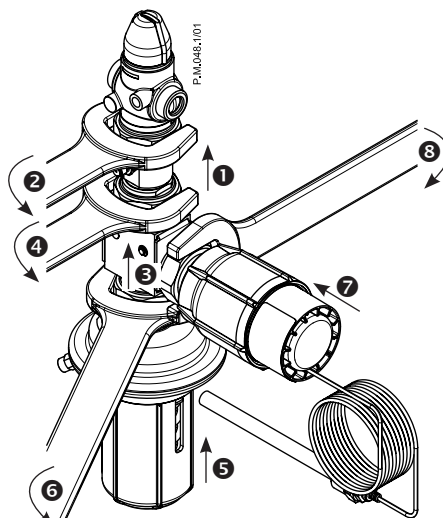

1

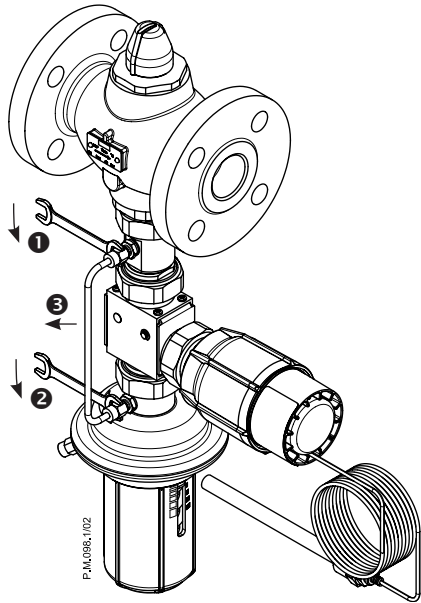

2

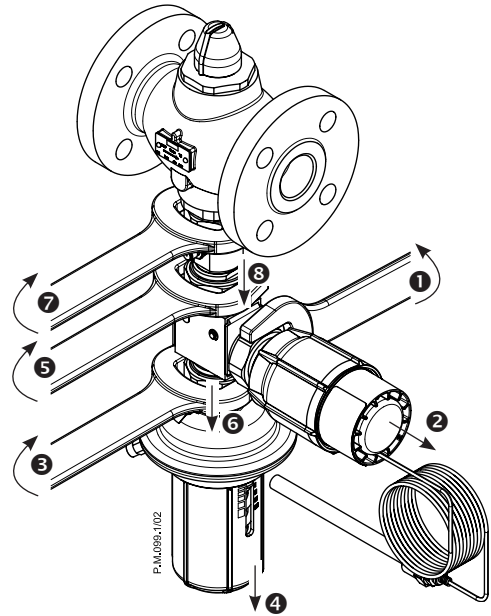

3

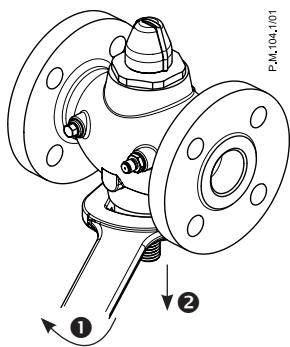

4

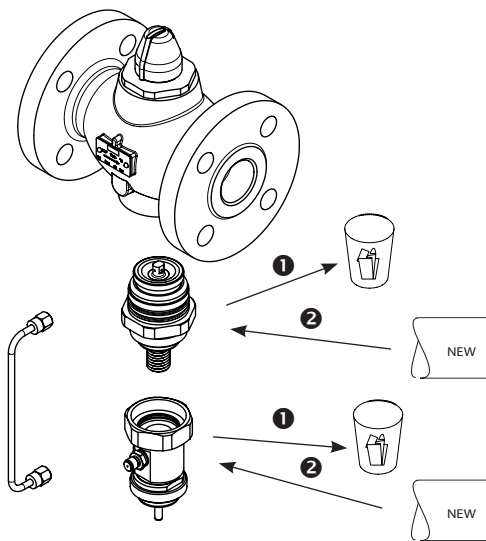

5

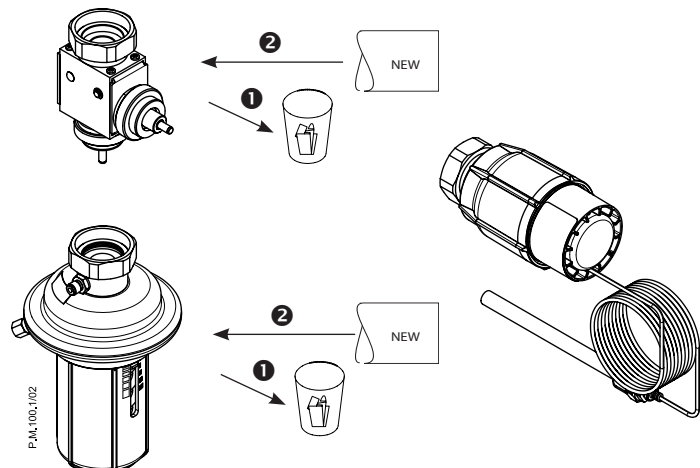
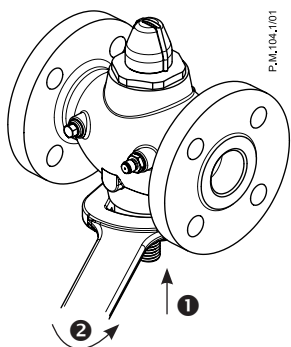

7

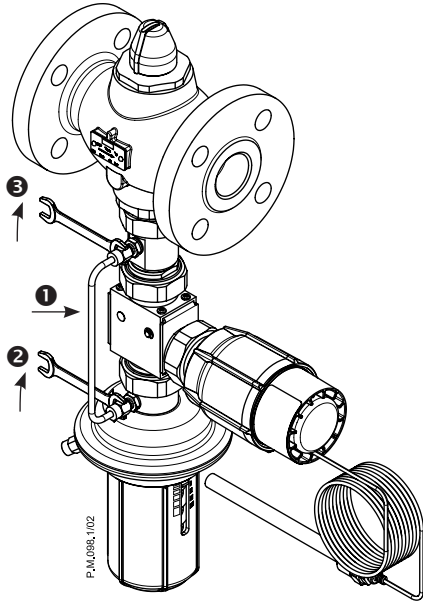

6

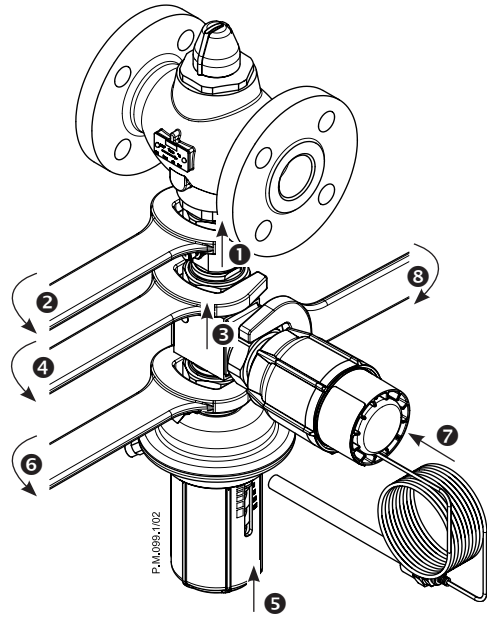



1

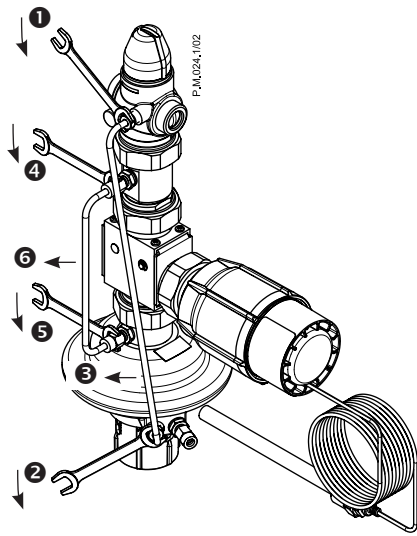

2

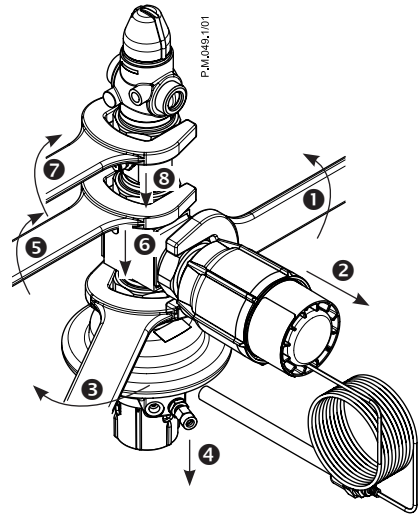

3

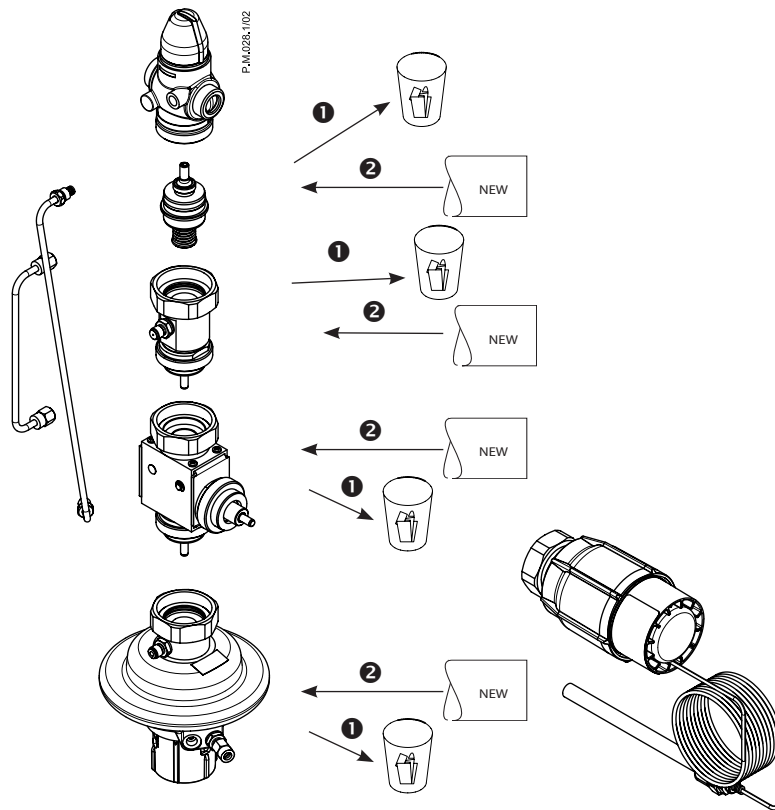

5

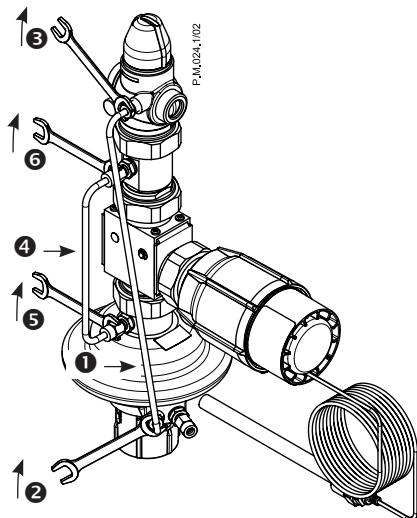

4

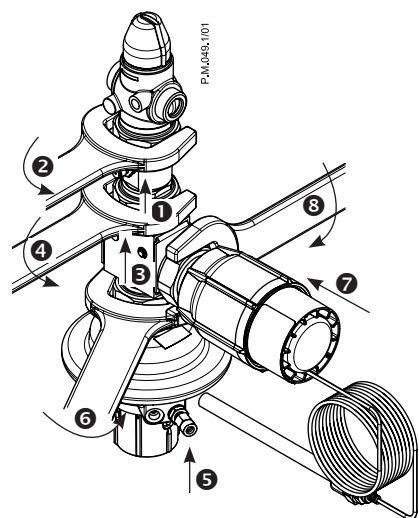

1

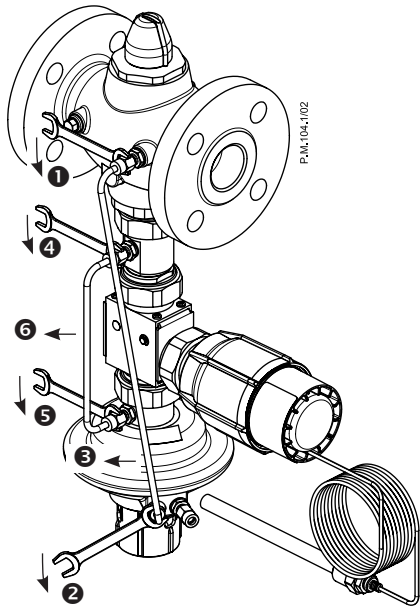

2

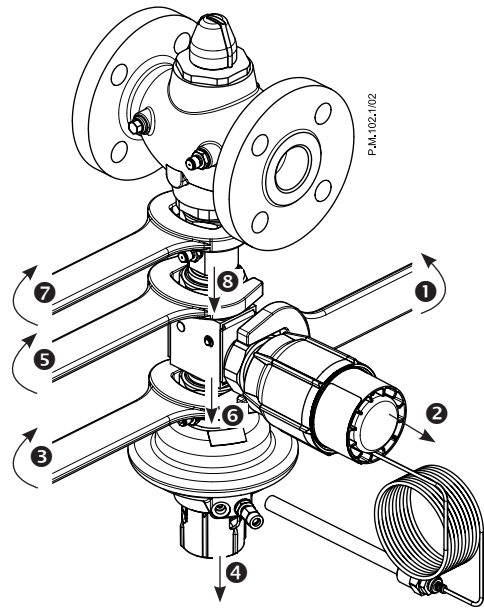

3

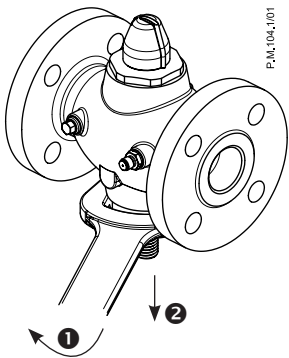

4

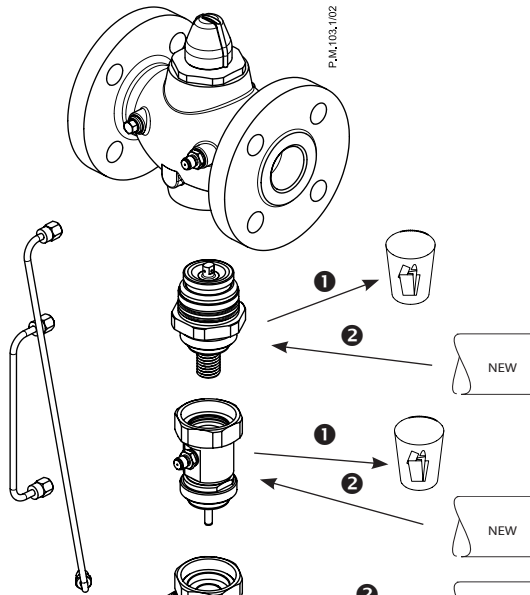

5

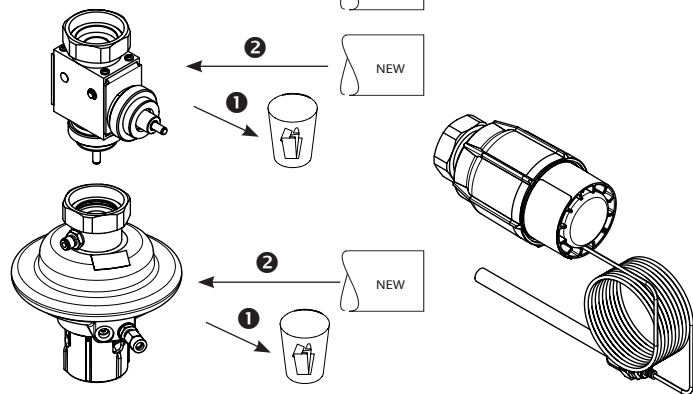
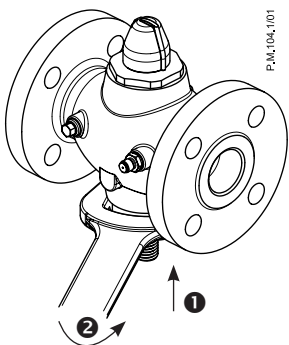



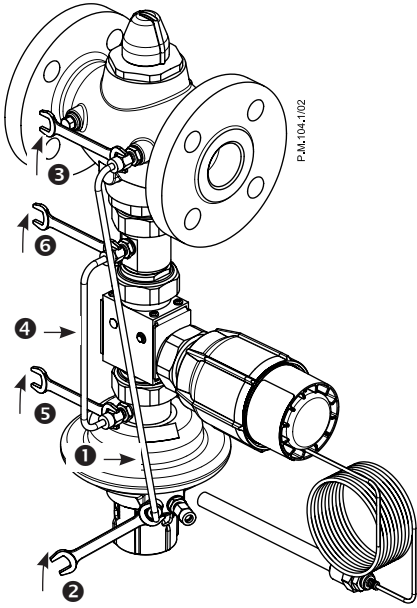

7

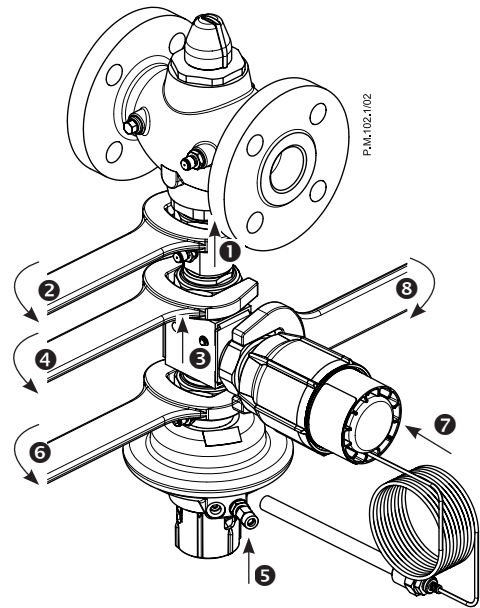

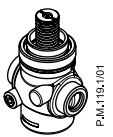
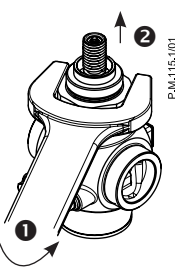
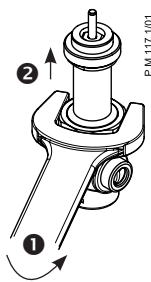
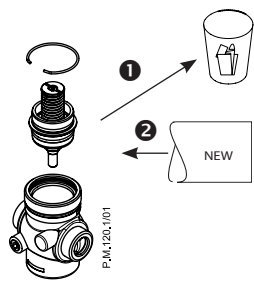
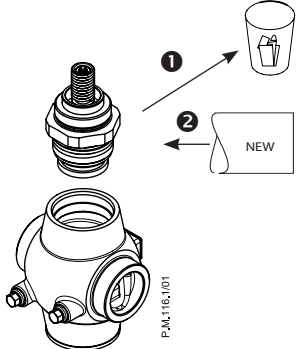
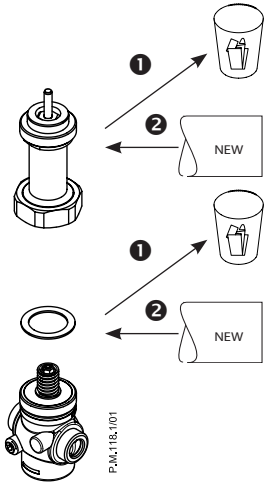
6

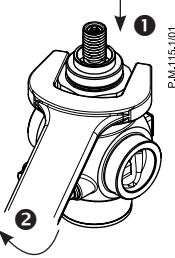
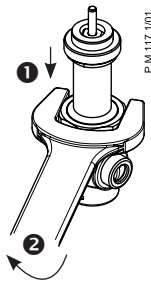

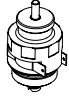
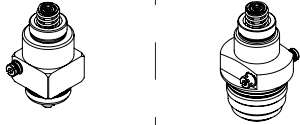
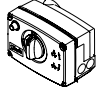
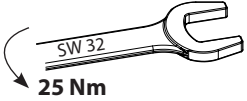
PN 16	VG	M1	PN 25	VG, VGF	M2	PN 16	VGS	M1
1	 <p>P.M.118.1/01</p>		1	 <p>P.M.115.1/01</p>		1	 <p>P.M.117.1/01</p>	
2	 <p>P.M.120.1/01</p>		2	 <p>P.M.118.1/01</p>		2	 <p>P.M.118.1/01</p>	
3	 <p>P.M.118.1/01</p>		3	 <p>P.M.115.1/01</p>		3	 <p>P.M.117.1/01</p>	

PN 16	M1	PN 25	M1	M2	<table border="1"> <tr> <td>M1</td> <td>CuSn5ZnPb (Rg5)</td> </tr> <tr> <td>M2</td> <td>EN-GJS-400-18-LT (GGG 40.3)</td> </tr> </table>	M1	CuSn5ZnPb (Rg5)	M2	EN-GJS-400-18-LT (GGG 40.3)
M1	CuSn5ZnPb (Rg5)								
M2	EN-GJS-400-18-LT (GGG 40.3)								
					<b>AMV(E)</b>   <b>25 Nm</b>				
									

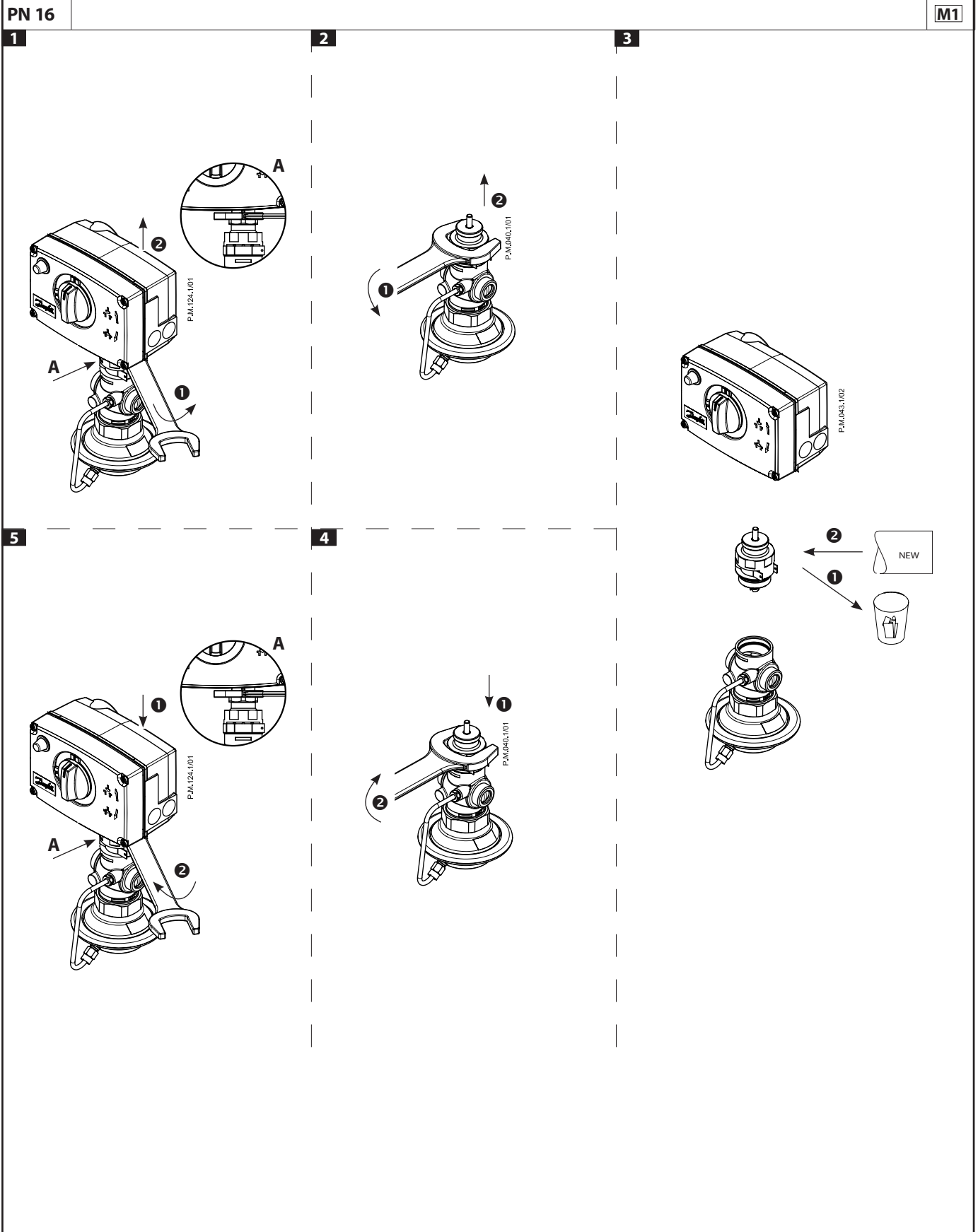

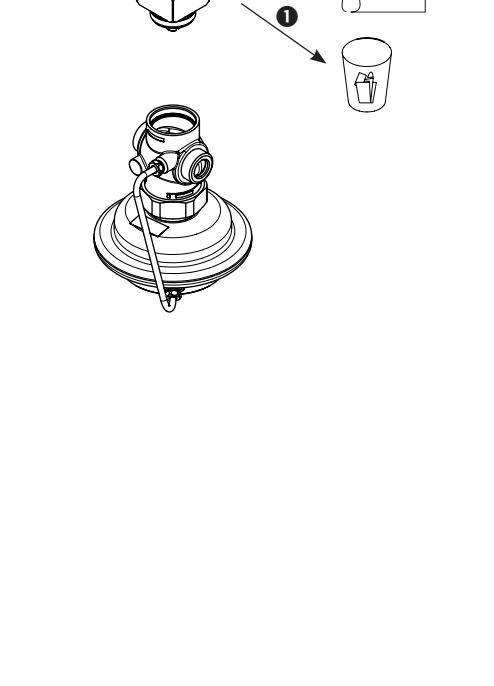
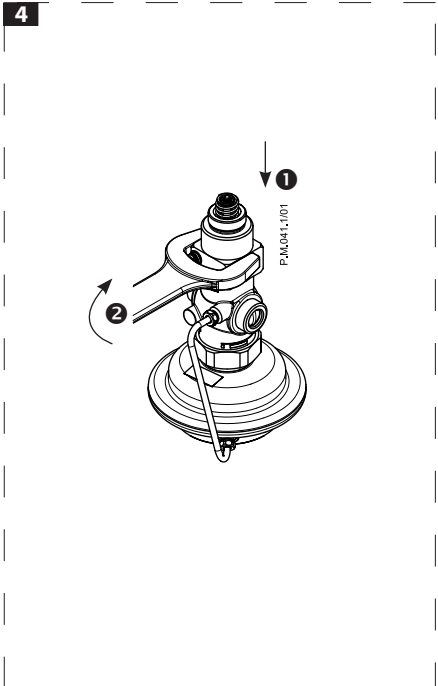
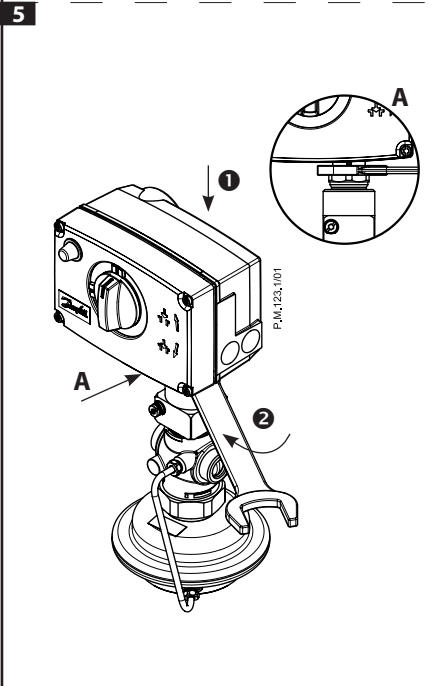
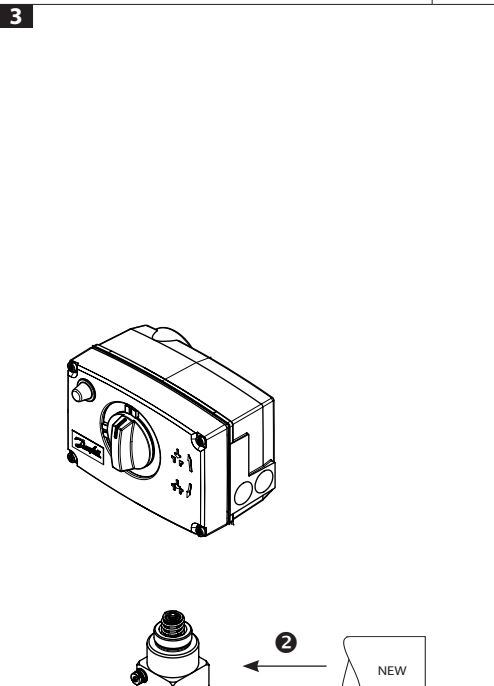
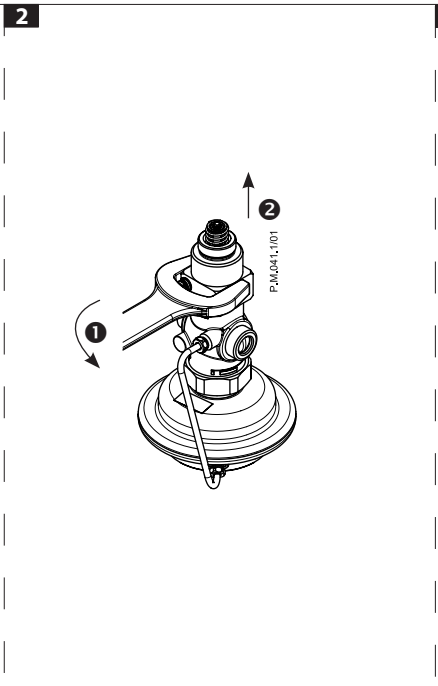
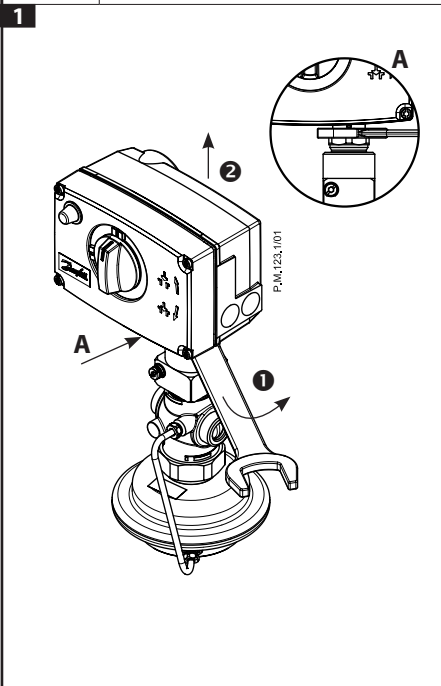



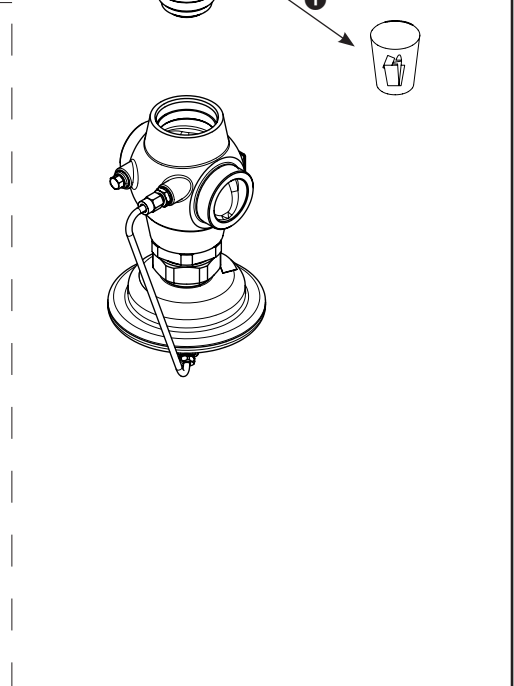
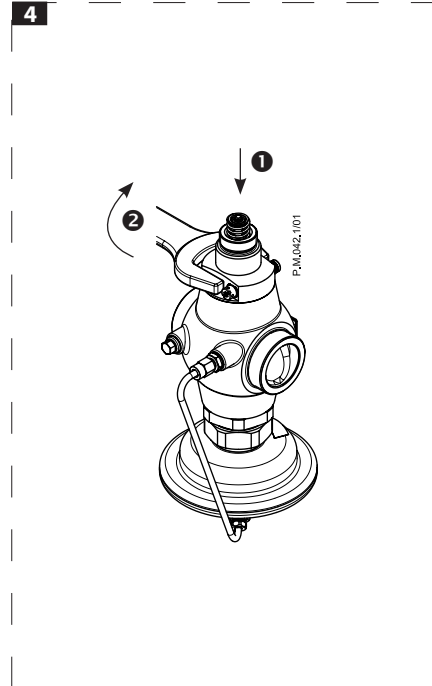
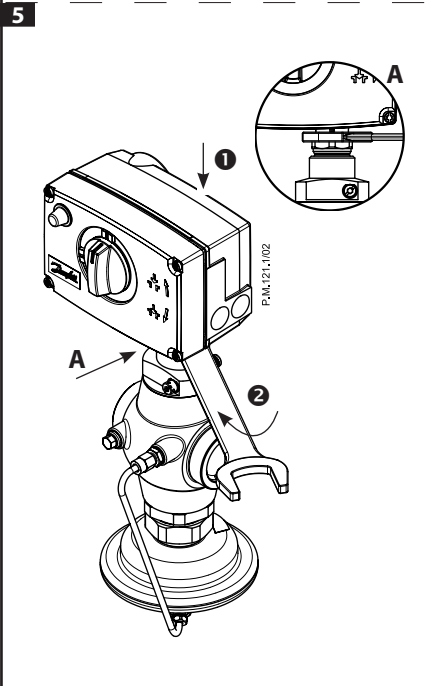
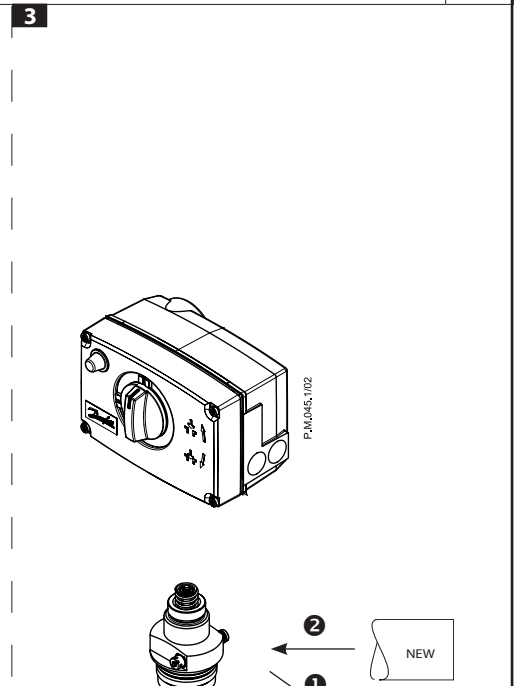
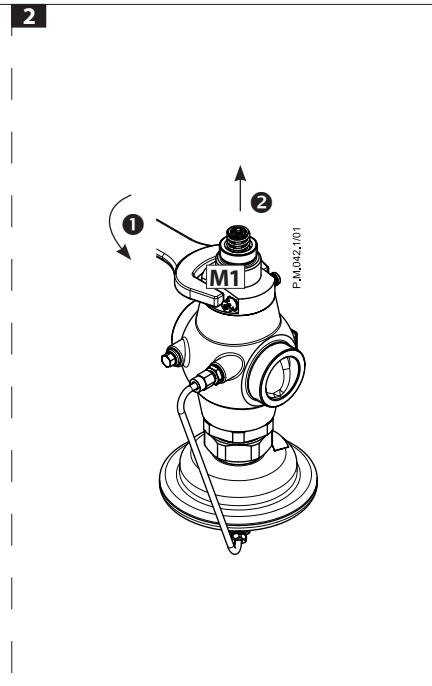
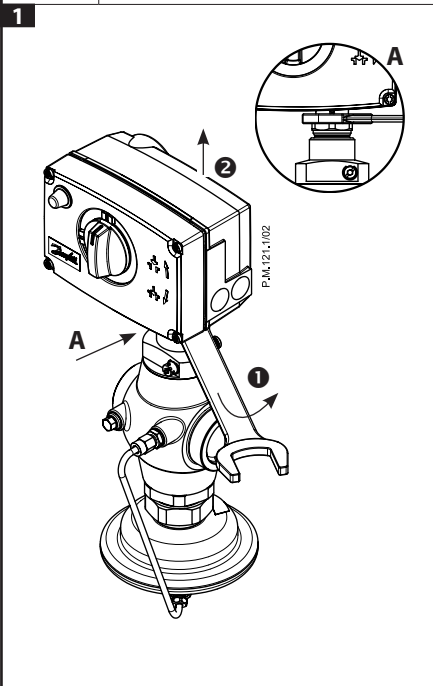

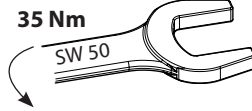
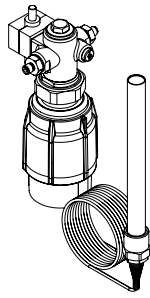

PN 25 STL

M1, M2

1

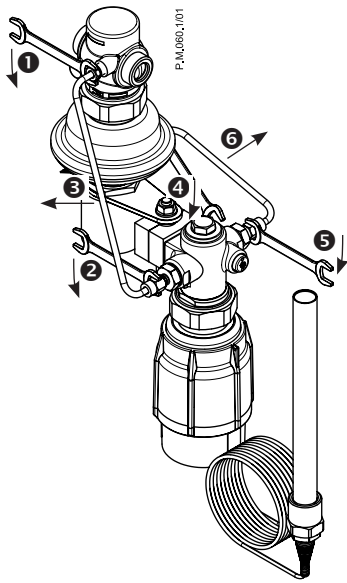

2

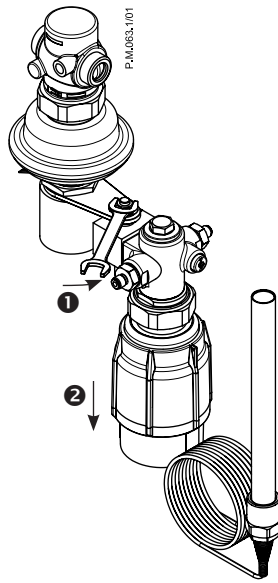

3

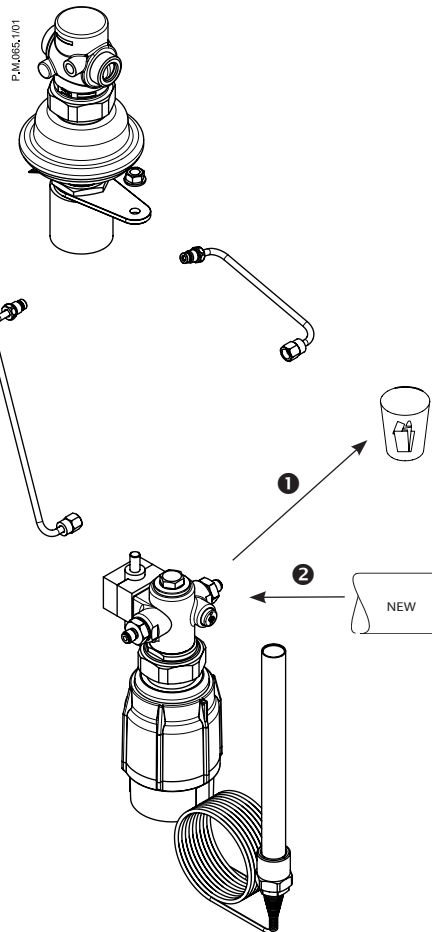

5

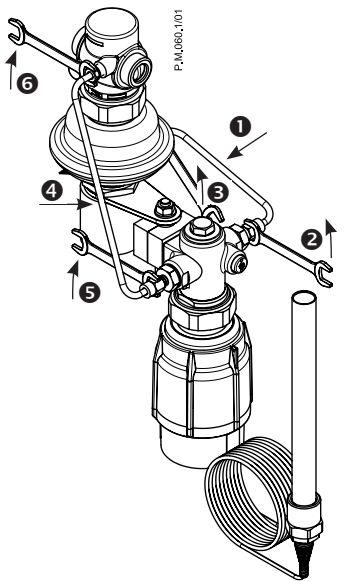

4

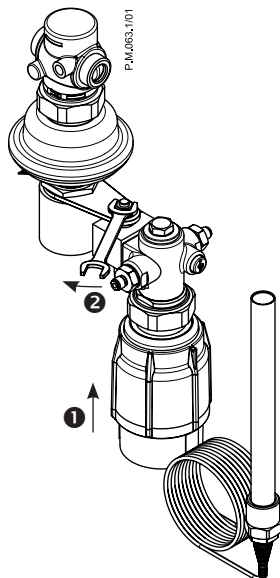

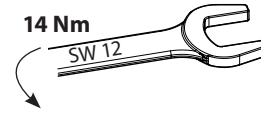
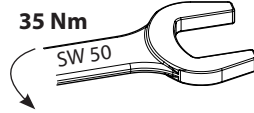
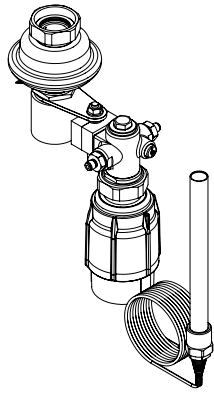

PN 25 STL

M1, M2

